

PALAPALA SILA NUI – HISTORY OF ROYAL PATENT LAND GRANTS ON CROWN AND GOVERNMENT LANDS OF LĀNA‘I

This paper is meant to provide readers with an overview of the history of Palapala Sila Nui (Royal Patent Land Grants) on the island of Lāna‘i. We have included information from Hawaiian language newspapers, survey and land agent records, field notes, records of survey and plot plans for each of the land grants issued to applicants on Lāna‘i. We also include a summary of the transitions in land tenure practices following western contact and the codification of land laws in the Hawaiian Kingdom.

Events Leading to Fee-Simple Acquisition of Land in the Hawaiian Islands

Following the arrival of Captain Vancouver in 1793, the visits of foreign ships began to increase. In the early 1790s, only two Caucasians were recorded as being residents in the islands, by 1800, the number of foreigners who jumped ship grew. As the numbers of ships calling on Hawaiian ports increased, there also arose new economic pressures. Hawaiian interest in foreign goods evolved, and foreign desires for Hawaiian supplies and safe harbors grew as well. Of significance, foreign vessels also brought with them herbivores which they unloaded from the ships onto the islands, as a means of providing protein resources to wintering ships. These “grazing” animals intruded into native forests and Hawaiian agricultural lands, laying waste to everything they ranged through.

In 1820, Calvinist missionaries from America arrived and settled the islands. They brought with them not only their religious beliefs, but also their American values—among which were private property rights. By the middle 1820s, lands were being granted to the American Board of Commissioners for Foreign Missions (A.B.C.F.M.), for church, residency, schools, and the development of businesses with which to support the growing Sandwich Islands Mission. By the 1830s, other foreigners who had provided some service or other assets to the King and his chiefs, were also receiving lands for their use. Such property rights led to the development of sugar plantations and ranching interests. The latter, becoming an urgent need, in order to control the growing herds of wild cattle and other ungulates left in the islands by Captain Vancouver and later visiting ships (cf. Kuykendall 1968:40-41).

Between 1800 to 1850, a radically different system of foreign economics evolved in the islands, generally to the disadvantage of the Hawaiians. By the middle 1840s King Kamehameha III, under the tutelage of his missionary teachers, began to organize his Kingdom birth-right under an American system—a system which also incorporated many foreign office holders. From his land inventory, he set up a mechanism to lease out and eventually sell large tracts of land for the development of businesses, which it was hoped, would also benefit the kingdom.

The sale of Hawaiian land to foreigners, and their growing role in the Hawaiian government caused many native Hawaiians concern, and in 1845 several thousand Hawaiians from across the islands submitted petitions to the King and his ministers, with the basic suggestion that the King:

...Permit no naturalized foreigner to hold any office. To allow no foreigners hereafter to become naturalized. To part with no lands to foreigners... [The Polynesian, July 26, 1845:40]

In April 1845, an important record from native residents of Lāna‘i was prepared and forwarded to the King. The document listed twelve issues and suggestions on the matter of the foreign role in the Hawaiian government, and sale of Hawaiian land to foreigners. Housed in the Interior Department, Miscellaneous files of the Hawai‘i State Archives, the record is particularly significant, in that it is the earliest document found to date, which names hundreds of residents of Lāna‘i. Most records, preceding and postdating this petition, only reference residents of Lāna‘i in passing, at best, naming only a few individuals. It is also important to note that at the time of the petition in early 1845, 301 individuals with interest in land matters on Lāna‘i were named. Three years later, during the Māhele, only 112 individuals made claims for land on Lāna‘i, and at the close of the Māhele, only 51 individuals

were actually awarded land. A full transcript (Hawaiian and English) of the petition follows below, along with photo images of the original record:

Lanai, Apelila 1845

E ka Moi hanohano o na moku puni 12, aloha nui oe a me ke Kuhina ka mea kiekie malalo iho ou, a me kou poe malalo aku. E maliu mai a nana mai i ko oukou poe kini a me na palalepo o kou Aupuni mai ka po mai a hiki i kou makuakane ia Kamehameha I. Ke noi aku nei makou ia oe a ke Kuhina a me ko makou poe haku malalo iho ou i pomaikai nou mau loa a me kau poe hooilina pono i aku a me kau mau kauwa o na makaainana a pau loa. A eia malalo iho ka manao nei.

1. No ke kuokoa ana o ke Aupuni Hawaii.
2. Hoole i na luna haole i kohoia i luna no ke Aupuni Hawaii.
3. Aole o makou makemake e hooihiki no na hoole i kanaka Hawaii.
4. Aole o makou makemake e kauia ka auhau pohihihi i kau poe makaainana.
5. Aole o makou makemake i kuai hou aku oe i kekahi apana aina o kou Aupuni i na haole.
6. O ka pilikia a me ka makai i ke kaumaha e loohia mai ana.
7. Mai makau oe no ko makou noi ana aku, no ka mea, o oe no ko makou makua.
8. Mai hopohopo oe no ka uuku o ka waiwai o kou Aupuni i kou poe pono.
9. Aole o makou makemake e wehe mai oe i ka puka e komo mai ai ko na aina e.
10. Mai nana oe i na olelo kiekie a ke kanaka naauao, no ka mea, aole oe i makaukau i na hana naauao ko makou Makua, pela no hoi makau kau poe keiki pono.
11. Hopohopo makau o kuhi mai ka naauao i ka naupo e like me Amerika a me kekahi mau aina e ae! Maluna au a me makou.
12. I ka wa o kou poe kupuna, he mea ma kau loa na lakou ke kiuhoopulu.

Ma keia mau mea maluna ae nei ke kakau nei makou i ko makou inoa.

<u>Poupou</u>	Paa	Kaaiokala	Opunui	<u>Lono</u>
Nika	Lahaba	Polani	<u>Ohua</u>	<u>Kekuakaulu</u>
<u>Kaiwi</u>	Laakila	Kahololio	Kamakaiola	Ounui
Keauhana	Miki	<u>Kalawaia</u>	Kahea	Opu
Kukiihahu	Liilii	Kahuna	Opunui 2	<u>Kalawaia</u>
<u>Mahoe</u>	Naliko	Kalaaunui	Kamakauhaole	Lumahimaina
Kulepe	Makaoha	Kaloanui	Kaihuolua	<u>Nalimakaua</u>
Kekipi	Aumoana	Puuhawali	Kaiu	<u>Mano</u>
<u>Moo</u>	Holohua	Kaukaao	Kahawai	<u>Kekua</u>
<u>Koia</u>	Kahakaha	Kekapalau	<u>Kahili</u>	Kapua
Kuene	Hina	<u>Keloha</u>	Kaleikau	Kamaka
<u>Pauahi</u>	Kamakalohi	Lani	Kapukui	Kailua
Pio	Kaauwaikuia	Kamakanau	Kawaona	Keoho
Lawaole	<u>Kaka</u>	Piaholo	Kamala	Aki
Kaaukai	Uu	Kalauao	Kahikane	Hoimaihilo
Kaio	Haaheo	Poopuu	Kamakele	Pokanui

Mailou	Kekila	Ounui	Kalole	Kahele
Kaaumoana	Waiwaiole	Pupuka	Kahaukaula	Naliikipi
<u>Kapu</u>	Kahele	Nalepo	<u>Kapahoa</u>	Kaheewahine
<u>Keawe</u>	<u>Kauhi</u>	Mahiole	<u>Kapuhi</u>	Kailiuku
<u>Keamo</u>	Kukapu	Kalama	Kekoha	Makaono
<u>Maawe</u>	Opilopilo	<u>Kahukilani</u>	<u>Kalamama</u>	Kanuialoha
<u>Hoopapalani</u>	<u>Hoe</u>	<u>Kamakahiki</u>	Wailuia	<u>Muhee</u>
Uila	Namakahai	Hiiaka	Kalahu	<u>Napuulu</u>
<u>Pohano</u>	Kahua	Kau	<u>Makahi</u>	<u>Palaa</u>
Wailanalii	Hakawai	Kauhauhi	<u>Kaka</u>	<u>Kaia</u>
<u>Kuheleloa</u>	Piiapoo	Kumanomano	<u>Kapu</u>	Nunu
Poonui	Kula	Paliiki	Kainei	Kamakakuaaina
Kapa	Iona	Kaakau	Uilama	Kawaka
<u>Apolo</u>	Hina	Kainaina	Piliwale	Kohi
<u>Keie</u>	Keliimai	Mahaoi	Hoolawa	<u>Kaia</u>
<u>Kaukapala</u>	Kaniokalani	Uiha	Laea	Keaku
Kahalau	<u>Kawaihoa</u>	Poopuu	<u>Kaauwaeaina</u>	Kahina
Kahaloa	Kipi	<u>Paele</u>	Kua	Kanae
<u>Kalua</u>	Poopuu	Auwaioahu	Waihowale	Kapali
Kalauhiwa	Kaukapa	<u>Kaiole</u>	Luka	Kaululeolani
<u>Kahoau</u>	<u>Keloha</u>	Puhipuhi	<u>Kaaikaula</u>	Pukoikoi
Kamokumaia	Ihuole	Makai	<u>Kalehuamakanoe</u>	Kekuanui
Keahua	<u>Iwirole</u>	Pule	Ohimau	Paa
Keliikipi	Upai	Kolika	<u>Awa</u>	Paahana
Kekaua	Kailipeleuli	Hanui	Ainoa	Kaaea
Keakaikawai	Kaulaula	Kanekoa	Kaaiholei	Kauwehanehane
Kelulia	Kai	<u>Kaaiiai</u>	Kailikea	Kahakauila
Kuamu	Kapa	Kekoohiwiwa	Kawaa	Kaanaana
Kuualii	Hakuole	Kakue	<u>Pukai</u>	Kapua
Maile	Kauhae	Upai	Poloole	Kaluau
Minomino	Kaaumoana	Opunui	Kaaiakaia	Kuihewa
Makainiki	Kapoo	Kalauku	Maloli	Hinau
Nalii	Kahue	Kahewahewanui	Piimoku	Kapihenui
Nalua	Kaowi	Kawelo	Omali	Naoholaunui
Nakaikuaana	Keo	Hawawa	Pii	Okuu
Naiahelu	Kaliihue	Luapo	Kahalau	Kekea
Haoleaha	Kealakai	Nainoa	<u>Laukapu</u>	Kane
<u>Halimu</u>	Kuku	Aipo	Kopa	Naaoa
54	<u>Lono</u>	Pokaa	Ku	Kalalike
	<u>Manoa</u>	<u>Kalaniwahine</u>	Kekuanui	Hoolana
	Nawai	Kaha	Kamaka	Kalehua
	57	Pelekila	Kainaina	Hilia
		Bemaela	Pulahalaha	Pohai
		Kauo	<u>Nahula</u>	Kiha
		59	Nahili	Oopu
			Poohina	Kawai
			<u>Naoopu</u>	Hoaliku
			63	Alika
				Holianoa
				Kapeahi
				Keliikoa
				68

Huipu makou ekolu haneli me kahi (301) iloko o ke apo.

Aloha Nui Ka Moi. [Hawaii State Archives – Interior Department, Misc. April 1845]

[Note: Underlined names are those who also claimed lands as a part of the Māhele, Royal Patent Land Grants, or who were identified in other land records of the Kingdom. Also note: A few names were difficult to read, and may not be the correct spelling.]

Lanai, April 1845.

O honored Sovereign of the 12 Islands, great love to you, to the distinguished ministers below you, and those under you. Listen and look upon your many people who are like the daubs of earth belonging to your Kingdom, from antiquity to your father, Kamehameha I. We hereby petition you, the Ministers and those who rule over us, below you, that you may be always blessed, as well as your own heirs, and your servants, and all the people of the land (commoners). Here below, is what we think to ask:

1. For the independence of the Hawaiian Kingdom.
2. Do not let foreign advisers be appointed as advisers to the Hawaiian Kingdom.
3. We do not want foreigners sworn in as Hawaiian citizens.
4. We do not want bewildering taxes levied upon your commoners.
5. We do not want you to sell another parcel of the land of your kingdom to any foreigners.
6. For there is trouble and fear of the burden that will eventually result.
7. You do not need to be afraid of our petition, for you are our father.
8. Do not be concerned that you Kingdom and people are not rich.
9. We do not want you to open the doors to the coming of those of other lands.
10. Do not pay attention to the haughty words of the intelligent people, though you are not prepared, act wisely our father, that is what we your own children ask.
11. We are concerned that the wise ones, like American and other lands, will tread upon those who are ignorant, such as we who are your own citizens.
12. In the time of your ancestors, they greatly feared the spies.

To these things above, we hereby sign our names.

[See list above]

We total three hundred and one (301), all together.

With Great Love to the King. [Maly, translator]

Lāna'i, Apelila, 1845.

E ka Māi hauhaau o na kōkōpuni 12, aloha nui se
 a me ke kūhina o ka mea hekeheke malalo iho se, a me kōu poe
 malalo aku, o Malie ma a nana ma e kōu poe hekeheke a me
 na pōhōpō o kōu kōkōpuni ma ka pō ma a hiki i kōu
 mahūakani o Kamehameha 1. E nō aku nō mākou i
 a ke kūhina a me ke mākou poe haku malalo iho se
 o pōhōpō nō ma a lōa a me kōu poe kōhōpō pōhōpō
 a me kōu ma a kōu a na mākaainana a pōu e a. O
 o malalo iho ke māna nō.

- 1 O ke kūhina a me ke kōkōpuni Hawaii
- 2 Hoohi i na luna hoohi i kōhōpō a luna
nō ke kōkōpuni Hawaii.
- 3 Hoohi o mākou mākaikai e hoohi na kōu
a i kōu kōkōpuni Hawaii.
- 4 Hoohi o mākou mākaikai e kōu kōu kōu
kōu hoohi i kōu poe mākaainana.
- 5 Hoohi o mākou mākaikai e kōu kōu kōu
aku se i kōu kōu kōu a me kōu kōu
kōu i na kōu.
- 6 E ka pōhōpō a me ke mākaikai i ke kōu
mākaikai e kōu ma a.
- 7 Māi mākaikai se nō ke mākaikai nō ma a
aku, nō ke ma a, a se nō ke mākaikai
ma a.
- 8 Māi hoohi se nō ke kōu kōu a ke kōu
kōu a kōu kōkōpuni i kōu poe pōhōpō.
- 9 Hoohi o mākou mākaikai e kōu ma a
i ka pōhōpō a kōu ma a i ke ma a.
- 10 Māi mākaikai se i na kōu kōu a ke kōu
ka kōu, nō ke ma a, a se nō ke kōu
kōu a me kōu ma a nō ke kōu
kōu kōu, pōhōpō nō ke mākaikai kōu
u poe kōu pōhōpō.
- 11 Hoohi mākaikai o kōu ma a ke kōu
i ka kōu kōu e like me Amerika a me
kōu ma a kōu kōu a me kōu ma a
mākaikai.
- 12 E ka wa o kōu poe kōkōpuni, ke ma a ma
ka lōa na kōu ke kōu kōu.

Lāna'i Petition of April 1845 – Part 1 (Hawaii State Archives – Interior Department, Misc.)

In December 1845 and January 1846, King Kamehameha III, Cabinet Members and Ministers, visited Maui to address the people on these matters. Kamehameha III; J.Y. Kānehoa, Governor of Maui; A. Pākī; and appointed Ministers met with Hawaiians in large gatherings at various locations. The following excerpts from *The Polynesian*, summarize the thoughts of the King and others in his government on these matters, and make specific reference to the “experiment” of dividing and granting fee-simple interest in properties at selected locations in the islands. By this time, wild cattle and other ungulates had already led to the abandonment of lands by natives at various locations—while not specifically mentioned, Lānaʻi was already suffering from the impacts of the feral animals as well, and at the closure of the Māhele, the fears expressed in the petition began to greatly manifest themselves in the lives of the native tenants.

The Polynesian
Honolulu, Saturday, Feb. 14, 1846
His Majesty’s Late visit to Maui.

...The royal party left this place on the 18th of December and arrived at Lahaina on the 20th... On the 12th January, His Majesty addressed several thousand of his subjects, at Wailuku, to the following effect:

I have addressed you before with my KUHINA, who is gone. I alone am left. I now repeat the same, and urge you to support schools and cultivate the land.

We are seeking the good of the country, but the work is not done. We are making laws, but they are not pohihihi [bewildering]. If they are so to us, they will be so to you. Your hereditary chiefs have been in trouble, and therefore have chosen some to aid them. They are the ministers of white skin, whom you see. This is according to the old system. They know more than we, and I have chosen them for the sake of their knowledge. You have heard of our trouble. I have seen it.

Therefore, we have chosen these helpers to help you. We have heard of your petitions. Should we consent to them, trouble would immediately follow— instantly—before night. I ask you therefore to put an end to your wish to promote that petition...

...On the 14th, His Majesty addressed a large concourse of people at Makawao with great effect. A large proportion of the assembly were melted into tears. The Premier followed, urging the people to attend to useful knowledge, agriculture and religion, as the king provided for his own children, he provided for theirs. Mr. Judd then spoke of the new arrangement of selling lands in fee simple to the natives...with which they were much gratified... Agriculture on Maui is in a forward state, compared with Oahu... There are 12 foreigners here, one of whom John White, arrived in 1799. On some parts of Maui, the cattle have done much mischief by trespassing on the plantations, and driving the owners from their little farms. Two districts have in consequence been deserted...

These efforts led to the Māhele ʻĀina (Land Division) of 1848, which met with mixed results. More than half the applications made by native tenants of Lānaʻi for kuleana (personal property rights) were rejected by the Land Commission (see the Māhele ʻĀina on Lānaʻi). This problem was recognized while the Māhele was being undertaken, and Kamehameha III implemented the program that allowed native and foreign residents to apply for grants of land—in fee-simple interest—which were held in the Government Land Inventory.

The process of applying for “Grant Lands” was set forth by the “Enabling Act” of August 6, 1850, which set aside portions of government lands for grants, as described below:

Section 4. Resolved that a certain portion of the Government lands in each Island shall be set apart, and placed in the hands of special agents to be disposed of in lots of from one to fifty acres in fee simple to such natives as may not be otherwise furnished with sufficient lands at a minimum price of fifty cents per acre. [“Enabling Act” – DLNR 2-4]

The Kingdoms’ policy of providing land grants to native tenants was further clarified in a communication from Interior Department Clerk, A. G. Thurston, on behalf of Keoni Ana, Minister of the Interior, to one of the Government Land Agents:

February 23, 1852

...You will entertain no application for the purchase of any lands, without first receiving some part, say a fourth or fifth of the price; then the terms of sale being agreed upon between yourself and the applicant you will survey the land, and send the survey, with your report upon the same to this office, for the Approval of the Board of Finance, when your sales have been approved you will collect the balance due of the price; upon the receipt of which at this office, the Patent will be forwarded to you.

Natives who have no claims before the Land Commission have no Legal rights in the soil.

They are therefore to be allowed the first chance to purchase their homesteads. Those who neglect or refuse to do this, must remain dependant upon the mercy of whoever purchases the land; as those natives now are who having no kuleanas are living on lands already Patented, or belonging to Konohikis.

Where lands have been granted, but not yet Patented, the natives living on the land are to have the option of buying their homesteads, and then the grant be located, provided this can be done so as not to interfere with them.

No Fish Ponds are to be sold, neither any landing places.

As a general thing you will charge the natives but 50 cents pr. acre, not exceeding 50 acres to any one individual. Whenever about to survey land adjoining that of private individuals, notice must be given them or their agents to be present and point out their boundaries... [Interior Department Letter Book 3:210-211]

Following the closure of the Māhele, between 1855 to 1867, thirteen (13) grant applications, covering 735.93 acres, were surveyed and patented to fourteen individuals (13 natives and one foreigner) on the island of Lāna‘i. Most of the native claimants had also applied for land as a part of the Māhele ‘Āina—some grantees received awards, others did not. The land came from the Crown and Government inventory of lands in four ahupua‘a (see Table 1).

Table 1. Palapala Sila Nui (1855-1867) Island of Lāna‘i

Grant No.	Grantee	Location	Acreage	Book	Year
1928	Koiku	Pawili	34.93	10	1855
1929	Kekua	Pawili	18.57	10	1855
1930	Nalimakaua	Pawili	31.96	10	1855
1931	Makaiholoae	Pawili	18.3	10	1855
2214	Lonopaawela	Pawili	1.64	12	1857
2903	Puupai	Pawili & Kealia Aupuni	52.00	14	1863
2971	Kapahoa	Pawili	33.00	14	1864
3029	Nahuina & Keliihue	Kalulu	236.68	14	1866
3030	Kapeleaumoku	Pawili	32.00	14	1866
3031	Kaaina	Kealia Aupuni	99.07	14	1866
3032	Pali	Kaunolu	29.00	14	1866

3033	Keamo	Kaunolu	20.85	14	1866
3045	Wm. Beder	Kaunolu	128.00	14	1867

Surveys, Applications and Royal Patents Issued for Land Grants on Lānaʻi

In the records of the Hawaiʻi State Archives and resources of the Hawaiian language newspapers, are found communications which provide readers with a record of the process of designating and approving Palapala Sila Nui on Lānaʻi. The Hawaiian language documents, including notes of survey have been translated by Kepā Maly as a part of this research.

Ka Hae Hawaii Malaki 5, 1856 (aoao 3-4)

He Waiwai Maoli ka Olelo a ke Akua no ko Hawaii Nei.

I keia malama i hala iho nei, ma Lanai au i ke kuai aku i na aina aupuni i na kamaaina o Lanai, a ua ike au i kekahi Heiau Hoomanakii a ka poe kahiko, ma Pawili, o Kahea ka inoa o ia Heiau. A kuhikuhi mai la kekahi kanaka elemakule ia'u i kekahi pohaku e waiho ana ma ka puka. He pohaku nui no, hookahi paha iwilei kona loihi, a he puka mawaena oia pohaku. Hai mai la oia, maluna oia pohaku, e hoonee ia'i na kanaka i hoomakaukau ia, i mau mohai no na kii akua, me ka paa o na lima i ke kaula, a hookomo loa ia ke kaula maloko o ka puka oia pohaku, i hiki ole ke holo a pakele i ka make ka mea e hoopaa ia'na i mohai.

Elua a'u mea i noonoo ai:

1. Ka poino i loa mai i na kupuna o kakou ma Hawaii nei, no ko lakou ike ole ana i ka olelo a ke Akua ke kumu; nolaila, nui wale na hana ino e poino ai lakou ia wa.
2. Ka pomaikai o ko Hawaii nei no ka hiki ana mai o ka olelo a ke Akua, a haalele ia kela mau hana lapuwale o ka wa naaupo.

I iho la au iloko o'u iho, Owai la ka mea e hiki ke helu i na pomaikai he nui wale i loa mai i ko Hawaii nei, no ka hiki ana mai o ka olelo a ke Akua ma Hawaii nei?

Nolaila, e lawe kakou i keia waiwai oiaio no kakou iho, a i waiwai hooilina no ka kakou mau keiki a me kakou mau mamo aku, me ka nonoi aku i ke Akua, i ole oia e lawe i kana olelo mai keia aupuni aku, o uhi hou mai ka pouli, a hana hou ia kela mau hana weliweli o na lahuikanaka ike ole i ke Akua e hana nei.

Ioane Richardson.
Waikapu, Maui. Dek. 12, 1855.

This past month, I was on Lanai to sell government land to the natives of Lanai, and I saw a Temple of Idol Worship of the ancient people, at Pawili. The name of the Temple is Kahea. An old man showed me a stone situated at the entry. It is a large stone, perhaps a fathom in length, with a hole through the stone. He told me that it was at this stone that a man would be tied in preparation for sacrifice to the idols. His hands would be secured with cordage, and the cordage secured through the hole in the rock, so the man could not escape. Then the one who was to be sacrificed was killed for the offering.

There are two things that I think of:

1. The many tribulations placed upon our ancestors in Hawaii, when they did not know the word of God as their source; therefore, they had a great many difficulties upon them in that time.
2. The blessings in Hawaii since the arrival of the word of God, and the abandoning of those foolish works in their time of ignorance.

I said to myself, “Who could possibly count the many blessings which have been obtained in Hawaii nei since the arrival of the word of God in Hawaii?”

Therefore let us take this rich truth for ourselves, and as a valuable bequest to our children and the descendents that follow, with the request that God not take his word from this kingdom, and we be returned to darkness, and the fearful works done by a nation that does not know God.

John Richardson
 Waikapu, Maui. Dec. 12, 1855. [Maly, translator]

Ka Hae Hawaii
Feberuari 4, 1857 (aoao 195)
Olelo Hoolaha

I Keia La ua koho o P. Nahaolelua, Kiaaina o Maui, a me na moku e pili ana, i na Luna Awa, a ua hoapono ka mea Kiekie, ka mea e hana ana i ka Oihana Kalaiaina ia lakou.

...Kaaina Lanai.

On this day, P. Nahaolelua, Governor of Maui chose, for their respective islands, the Awa agents, and approved by his Excellency, the one who is responsible for their work of the Interior Department.

... Kaaina Island of Lanai. [Maly, translator]

1864
Pawili Lanai
(Palapala Sila Nui Helu 2971)

Kapahoa, he aina kuai kona me ke aupuni ma Pawili i Lanai, he 33 eka, hookahi dala o ka Eka

Dala o ka Aina	33	
Dala o ka Sila	5	
Dala o ka Ana	10	48

Kaa mua ia loane Richardson	47
Kaa hope ia P. Nahaolelua	1

Ua kaa loa keia aina, ua hoihoiia ke dala i ke K. Kalaiaina.
 E nana ma ka Buke 2, aoao 28.
 Ua loaa mai ka P. Sila Nui, Helu 2971.

Ua haawi ka P.S. Nui, Helu 2971 ia Kenuipoohiwi, wahine a Kapahoa,
 13, Mei 1865. [Hawaii State Archives, DLNR 2 Vol. 37:29]

Kapahoa, he has a land purchased from the government at Pawili, Lanai. There are 33 acres, at one dollar per acre.

Price of the Land	33	
Price of the Patent	5	
Price of the Survey	10	\$48

Paid to Ioane Richardson	47
Paid to P. Nahaolelua	1

The land has been paid for in full, with the money returned to the Minister of the Interior.

Look in Book 2, page 28.
Given Royal Patent Number 2971.

Documents of Royal Patent Number 2971 were given to Kenuipoohiwi, wife of Kapahoa on 13, May 1865. [Maly, translator]

Dek. 31st 1865 to Mar. 31st, 1866

Na Aina Aupuni i kuai mua ia i ka wa o J. Richardson.

Government Lands previously sold in the time of J. Richardson:

Name of the Natives:	Lands:	Area:	Price per Acre
Nahuina & Keliiahue	Kalulu, Lanai	236.68	\$1.
Kaaina	Kealia, Lanai	99.07	\$1.
Keamo	Kaunolu, Lanai	20.85	\$1.
Kapeleaumoku	Pawili	5.31	\$1.
Kapeleaumoku	Pawili	26.75	\$0.62
Pali later received	Kaunolu	29.06	\$1.

Lahaina. 31st Mar. 1866.

P. Nahaolelua,
Agent to sell Government Lands of Maui. [Hawaii State Archives Interior Department Lands]

October 12, 1866

Na Aina Aupuni i kuai mua ia e John Richardson.

Government Lands previously sold in the time of J. Richardson:

Name:	Lands:	Area:	Price per Acre
William Beder	Kaunolu, Lanai	128	\$1.

P. Nahaolelua,
Governor of Maui. [Hawaii State Archives Interior Department Lands]

Jan. 16, 1867

Kaunolu, Lanai

(Palapala Sila Nui Helu 3033)

Keamo, he aina kuai kona me ke aupuni ma Kaunolu i Lanai,
He 20.85 Eka \$1.00 ka Eka:

No ka aina	20.87	
No ke Sila	5.00	
No ke Ana ana	8	33.87

Kaa mua ia loane Richardson	19.50
Kaa hope ia P. Nahaolelua	14.62

Ua kaa loa keia aina, ua hooiilia ke dala i ke Kuhina Kalaiaina. E nana ma ke Buke 2 aoao 24.

Ua loaa mai ka Palapala Sila Nui Helu 3033, ua haawi ia Keamo ma Ian. 16, 1867. [Hawaii State Archives, DLNR 2 Vol. 37:37]

Keamo has purchased land of the government in Kaunolu, Lanai.
There are 20.85 Acres at \$1.00 per Acre.

Price of the Land	20.87	
Price of the Patent	5.00	
Price of the Survey	8	\$33.87

Paid to loane Richardson	19.50
Paid to P. Nahaolelua	14.62

The land has been paid for in full, with the money collected by the Minister of the Interior. Look in Book 2, page 24.

The documents of Royal Patent Number 3033 were received and given to Keamo on Jan. 16, 1867. [Maly, translator]

**Kealia, Lanai
(Palapala Sila Nui Helu 3031)**

Kaaina, he aina kuai kona me ke aupuni ma Kealia i Lanai, he 99 7/100 Eka. \$1.00 Eka hookahi.

No ka aina	99.12	
No ke Sila	5.00	
No ke Ana ana	10.00	114.12

Ua kaa loa keia aina, ua hooiilia ke dala i ke Kuhina Kalaiaina. Buke 2 aoao 29.

Kaa mua ia I, Richardson	26.12
Kaa hope ia P. Nahaolelua	88.00

Ua loaa mai ka P. Sila Nui, Helu 3031, ua haawi ia ma ka lima o Lono. [Hawaii State Archives, DLNR 2 Vol. 37:37]

Kaaina has purchased land of the government in Kealia, Lanai, there are 99 77/100ths. At \$1.00 per Acre.

Price of the Land	99.12	
Price of the Patent	5.00	
Price of the Survey	10.00	\$114.12

The land has been paid for in full, with the money collected by the Minister of the Interior. Look in Book 2, page 29.

Paid to Ioane Richardson	26.12	
Paid to P. Nahaolelua	88.00	

Royal Patent Number 3031 has been received and given into the hands of Lono.
[Maly, translator]

**Kalulu, Lanai
(Palapala Sila Nui Helu 3029)**

Nahuina & Keliuhue, he aina kuai ka laua me ke Aupuni, Kalulu i Lanai, 236.68 Eka, hookahi dala o ka Eka 1.

No ka aina	236.75	
No ke Sila	5.00	
No ke Ana ana	20.00	261.75

Kaa mua ia Ioane Richardson	158.00
Kaa hope ia P. Nahaolelua	103.75

Ua kaa loa keia aina, ua hoiiia ke dala i ke Kuhina Kalaiaina. E nana ma ka Buke 2 aoao 31. Ua loa mai ka P. Sila Nui, Helu 3029, ua haawia ia Nahuina & Keliuhue. [Hawaii State Archives, DLNR 2 Vol. 37:38]

Nahunia & Keliuhue have purchased land of the government in Kalulu, Lanai. There are 236.68, at \$1.00 per Acre.

Price of the Land	236.75	
Price of the Patent	5.00	
Price of the Survey	20.00	\$114.12

The land has been paid for in full, with the money collected by the Minister of the Interior. Look in Book 2, page 29.

Paid to Ioane Richardson	26.12	
Paid to P. Nahaolelua	88.00	

Royal Patent Number 3031 has been received and given into the hands of Lono.
[Maly, translator]

**Pawili, Lanai
(Palapala Sila Nui Helu 3030)**

Kapeleaumoku, he aina kuai kana me ke aupuni ma Pawili i Lanai, he 32.06 Eka, he 5.31 Eka. \$1 Eka, he 26.75 Eka \$0.62 Eka. (Ma ke kii o keia aina he 32.06) Ua hanaia e like me ko ke kii.

No ka Aina	22.02	
No ke Sila	5.00	
No ke Ana ana	6.00	33.02

Kaa mua ia I. Richardson	11.50
Kaa hope ia P. Nahaolelua	21.50

Ua kaa loa keia aina, ua hoihoi ia ke dala i ke Kuhina Kalaiaina, Buke 2 aoao 21. Ua loa mai ka P. Sila Nui, Helu 3030. Ua haawii R.P. S. Nui ia Kapeleaumoku, Dek. 29, 1866. [Hawaii State Archives, DLNR 2 Vol. 37:38]

Kapeleaumoku has a land purchased from the government in Pawili, Lanai. There are 32.06 Acres and 5.31 Acres. 5.31 Acres at \$1.00 per Acre, and 32.06 Acres at \$0.62 per Acre. It is as described in the diagram.

Price of the Land	22.02
Price of the Patent	5.00
Price of the Survey	6.00 \$33.02

Paid to loane Richardson	11.50
Paid to P. Nahaolelua	21.50

The land has been paid for in full, and the money sent to the Minister of the Interior. Look in Book 2, page 21. Royal Patent Number 3030 has been received. The Royal Patent was given Kapeleaumoku, Dec. 29, 1866. [Maly, translator]

**Kaunolu, Lanai
(Palapala Sila Nui Helu 3032)**

Pali, he aina kuai kona me ke aupuni ma Kaunolu i Lanai, he 29.06 Eka \$1.0 ka Eka 1.

No ka Aina	29.06	
No ke Sila	5.00	
No ke Ana	5.00	\$39.06

Ua kaaloa keia aina.

Kaa mua ia I. Richardson	20.00
Kaa hope ia P. Nahaolelua	19.06

Ua hoihoi ia ke dala i ke Kuhina Kalaiaina i Mar. 31, 1866. E nana i ka Buke 2 aoao 27. Ua loa mai ka Palapala Sila Nui, Helu 3032. Ua haawii ia Pali. [Hawaii State Archives, DLNR 2 Vol. 37:39]

Pali has a land purchased from the Government in Kaunolu, Lanai, it is 29.06 Acres. At \$1 per Acre.

Price of the Land	29.06
Price of the Patent	5.00
Price of the Survey	5.00 \$39.06

Paid to loane Richardson	20.00
Paid to P. Nahaolelua	19.06

The money was returned to the Minister of the Interior on Mar. 31, 1866. Look in Book 2, page 27. Royal Patent Number 3032 has been received. It was given to Pali. [Maly, translator]

**Palapala Sila Nui Helu 1928
R. Koiku**

Ma ka Ahupuaa of Pawili, Mokupuni o Lanai.

E hoomaka ana ma ke kihi
Hikina o keia aina kahi i
hui ai o Kaohai me Pawili
e pili ana i ke Kahakai ma
ka aoao makai o ka Loko a
e holo ana i ka

Hema 35° Ko. 1282 pauku pili
me Kaohai;
Hema 54 ¾ ° Ko. 3150 pauku
pili me Kaohai;
Akau 24 ½ ° Hi. 2340 pauku
pili me Aupuni;
Ak. 60° Hi. 2324 pauku pili
me Kekua;
Hema 37° Hi. 5.47 pauku pili
me Kahakai,
hiki i ke kihi mua.
O kona ili 34 93/100 Eka.

Iloko o keia aina na Eka
Kahua Hale Pule Elua.

John Richardson
Mea ana aina.
Novemaba 11th, 1855.
Lahaina.

Translation:

Beginning Eastern corner
of this lands, at the place
where Kaohai and Pawili
meet at the shore, on the
beach side of the Pond,
and running to the:

South 35° West 1282 links adjoining Kaohai;
South 54 ¾ ° West 3150 links adjoining Kaohai;
North 24 ½ ° East 2340 links adjoining the Government land;
North 60° East 2324 links adjoining Kekua's land;
South 37° East 5.47 links along the Beach, to the corner of commencement.

Containing 34 93/100 Acres.

There are within this land, two acres for the Church Lot.

John Richardson,
Surveyor.
November 11th, 1855. Lahaina. [Maly, translator]

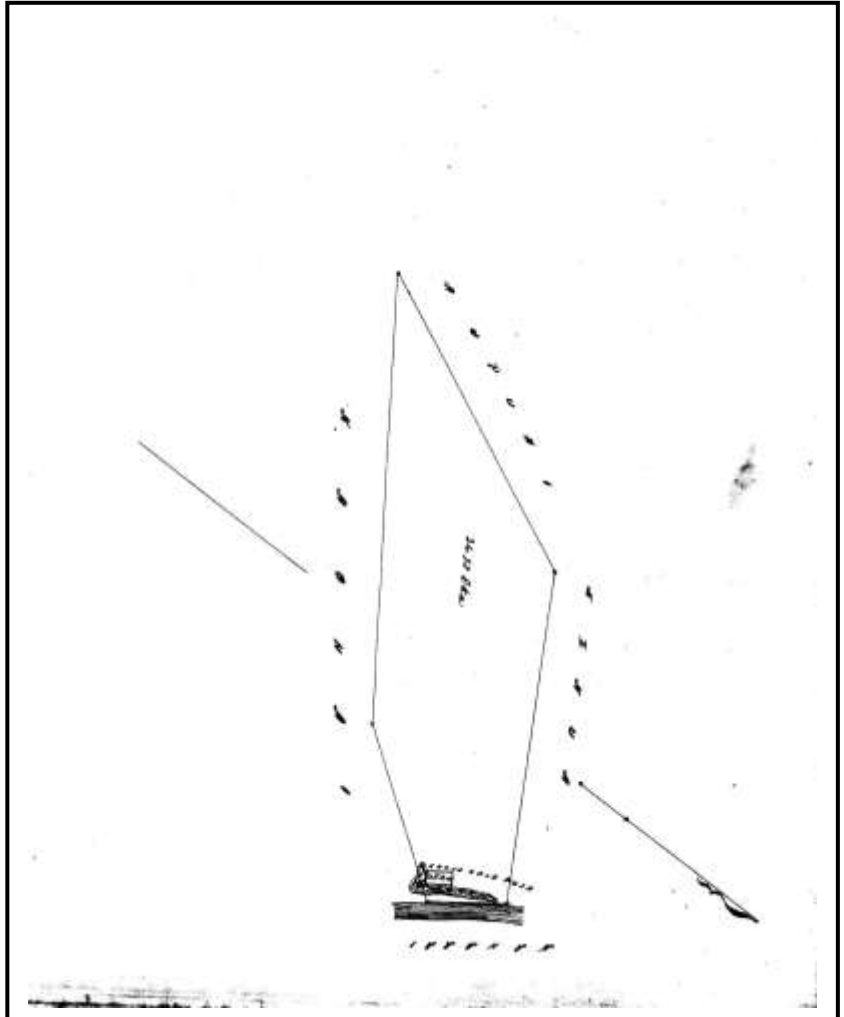

**Figure 1. Notes of Survey for Royal Patent Land
Grant No. 1928 to R. Koiku, at Pawili.
Hawaii State Archives.**

HELU 1928 ✓

PALAPALA SILA NUI.

Ma keia Palapala Sila Nui ke hoike aku nei o Kamehameha IV., ke Alii nui a ke Akua i kona lokomaikai i hoonoho ai maluna o ko Hawaii Pae Aina, i na kanaka a pau, i keia la, nona ilao, a no kona mau hope Alii, ua haawi lilo loa aku oia ma ke uno alodio ia *to Hokone*

i kona *wahi* kanaka i mana pono ia ia, i kela apana aima a pau o waiho la ma *Puwili* - ma ka Mokopuni o *Lanai*; a penei hoi ka waiho ana o na Mokuna:

Ke hoonoho ana ma keia Palapala Sila Nui i keia la, nona ilao, a no kona mau hope Alii, ua haawi lilo loa aku oia ma ke uno alodio ia to Hokone i kona wahi kanaka i mana pono ia ia, i kela apana aima a pau o waiho la ma Puwili - ma ka Mokopuni o Lanai; a penei hoi ka waiho ana o na Mokuna:

- Ma ka 31st Maun 1888 pumaka piki oia Hokone*
- Ma ka 1888 Maun 3160 " " "*
- Ma ka 20th Maun 2340 " " Mokopuni*
- Ma ka 6th Maun 2324 " " Hokone*
- Ma ka 27th Maun 517 " " Hokone*
- Ma ka 34th Maun 470 " " "*

Ma ka 34th Maun 470 oia Hokone, Ma ka 34th Maun 470 oia Hokone.

Palapala Sila Nui

[Faint, mostly illegible text, possibly a title or header section]

a maloko o ia Apana *31 5/7* eka a oi iki aku emi iki mui pala.
Eia ke kumu o ka lilo ana; ua haawi mai oia loko o ka waihona waiwai o ke Aupuni i *na maku*
ke \$22 7/8
Ako, ua koe i ke Aupuni na mine minerala a me na mine metala a pau.
No *Helehu*
ua aina la i haawiia, no *ma* mau loa aku no ma ke apo alodio a no ke *ma* mau hooiina, a me
ke *ma* waihona, ua-pili me ka nuhau a ka Poo Aholele e kau like ai ma na aina alodio a pau i keia
manawa i keia manawa.

A i mea e ike'i, ua kau wau i ko'u inoa, a me ka Sila Nui o ke Hawai'i
Pae Aina, ma Honolulu, i keia la *31 5/7*
Desemata, 1858

Haahumanu

Hamshamika

**Palapala Sila Nui Helu 1929
Kekua**

Aia ma ke Ahupuaa o Pawili, Mokupuni o Lanai.

E hoomaka ana ma ke kahi Hema ma kekahi pohaku e pili ana i ko ke Aupuni koena a e holo ana i ka:

Akau 60° Hikina 2324 pauku
pili me Aupuni;
Akau 42 ¾ ° Komo. 890 pauku
pili me Kai;
Hema 55 ¼ ° Komo. 2400 pauku
pili me Kapeleaumoku;
Hema 51 ½ ° Hikina 720 pauku
pili me Aupuni.

O kona ili 18 57/100 Eka.

John Richardson
Lahaina
Mea ana aina
Oct. 1855

Translation:

Beginning at the Southern
corner, at a stone along the
Government remnant and
running to the:

North 60° East 2324 links
along the Government;
North 42 ¾ ° West 890 links
along the shore;
South 55 ¼ ° West 2400
links along Kapeleaumoku;
South 51 ½ ° East 720 links
along the Government.

Containing 18 57/100 Acres.

John Richardson
Lahaina
Surveyor
Oct. 1855 [Maly, translator]

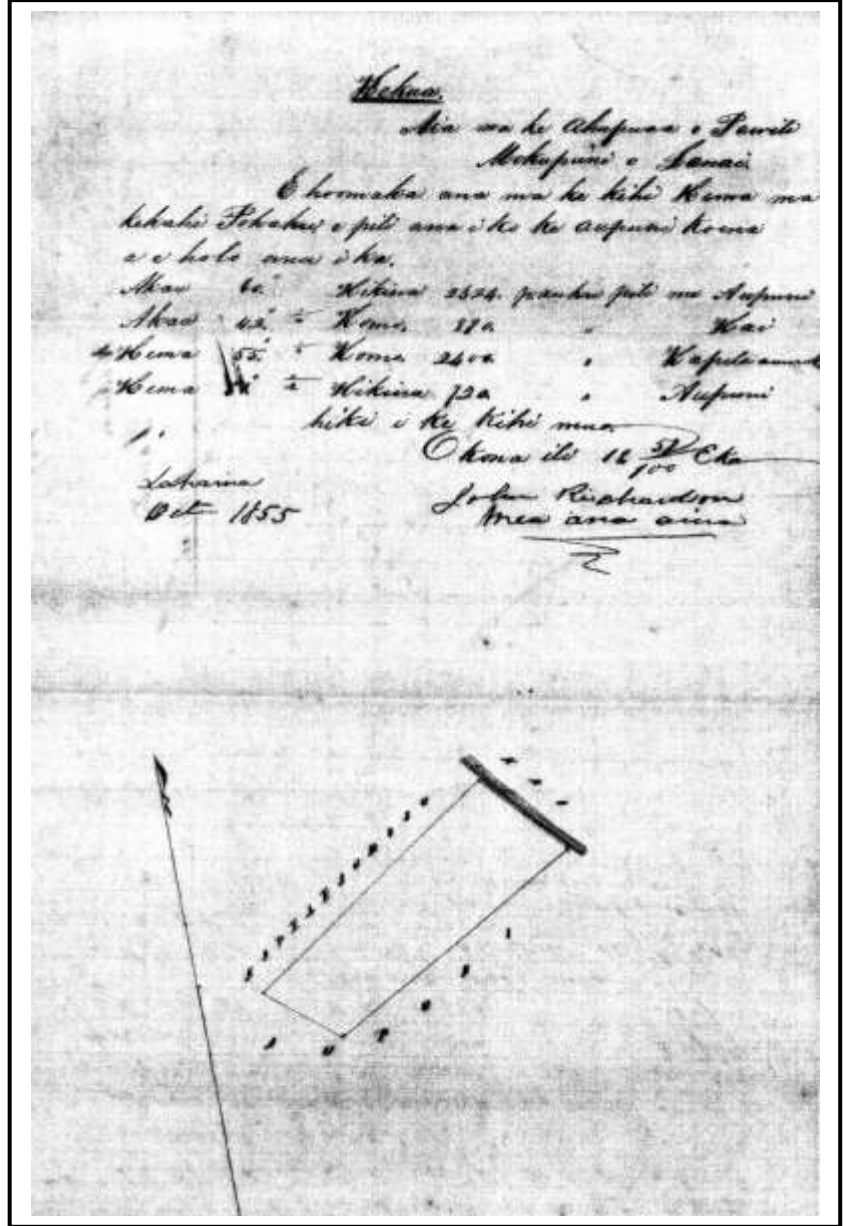

**Figure 2. Notes of Survey for Royal Patent Land Grant
No. 1929 to Kekua at Pawili.
Hawaii State Archives.**

HELU 1929

PALAPALA SILA NUI.

Ma keia Palapala Sila Nui ke hoike aku nei o Kamehameha IV., ke Alii nui a ko Akua i kona lokomaikai i hoonoho ai maluna o ko Hawaii Pae Aina, i na kanaka a pau, i keia la, nona iho, a no kona mau hope Alii, ma haawi lilo loa aku oia ma ke ano alodio ia *Hakua* i kona *wahi* kanaka i monoo pono ia ia, i keia npana aima a pau e waiho ia ma *Pawili* ma ka Mokopuni o *Lanani*; a penci hoi ka waiho ana o na Mokuna:

E hoomatua ana ana ka hiki. He mea ana ka hiki. He mea ana ka hiki. He mea ana ka hiki. He mea ana ka hiki.

- Ula 60° Hele 220 panta ana ka ka Aniani*
- Ula 45° Hele 190 " " Hele*
- Hele 55° Hele 240 " " Hele*
- Hele 60° Hele 70 " " Aniani*
- Hele i ka hiki ana Hele 100 Hele*

1875

a maloko o ia Apana *1875* eka a oi iki ako emi iki mui paha.

Eia ke kumu o ka lilo ana; ua haawi mai oia iloko o ka waihona waiwai o ke Aupuni i *1875*

1875
Aka, ua koe i ke Aupuni na mine minerala a me na mine metala a pau.

No *1875*

ua aina lu i haawia, no *1875* mau loa aku no ma ke ano alodio a no ke *1875* mau looilina, a me
ko *1875* waihona, ua pili nae ka zuhau a ka Poe Ahaolelo o kau like ai me na aina alodio a pau i kela
manawa i keia manawa.

A i mea e ikeai, ua kau wau i ko'u inoa, a me ka Sila Nui o ke Hawaii

Pae Aina, ma Honolulu, i keia le

Decemata, 1855

20

Haakuumana

Haakuumana

**Palapala Sila Nui Helu 1930
Nalimakaua**

Ma ke Ahupuaa o Pawili, Mokupuni o Lanai.

Apana 1. E hoomaka ana ma ka kihi Komohana Hema o keia aina e pili ana me ko Kapeleaumoku, a e holo ana i ka:

Akau 55° Hi. 3000 pauku pili
Kapeleaumoku;
Akau 42 ¼ ° Ko. 1270 pauku pili
Kahakai;
Hema 51° Ko. 2160 pauku pili
Makaiholoae;
Hema 2° Hi. 1290 pauku pili
Aupuni.
Hiki i ke kihi mua.

O kona ili 29. 76/100 Eka.

**Apana 2. E hoomaka ana ma ke
kihi Hikina loa o keia apana,
kekahi kihi i hui keia apana me
ko Keloha, a e holo ana i ka:**

Akau 6 ¼ ° Ko. 455 pauku pili
me Keloha;
Akau 62 ¾ ° Ko. 307 pauku pili
me Keloha;
Hema 47 ¾ ° Ko. 237 pauku pili
me Aupuni;
Hema 2 ¾ ° Ko. 335 pauku pili
me Aupuni;
Hema 79 ¼ ° Hi. 525 pauku pili
me Keloha;
Hiki i ke kihi mua.

O kona ili 2. 20/100 Eka.

Lahaina. Novemaba. 11, 1855.
John Richardson,
Mea ana aina.

Translation:

**Parcel 1. Beginning at the South
Western corner of this land, ad-
joining Kapeleaumoku's land
and running to the:**

North 55° East 3000 links
adjoining Kapeleaumoku;
North 42 ¼ ° West 1270 links adjoining the shore;
South 51° West 2160 links adjoining Makaiholoae;
South 2° East 1290 links adjoining the Government.
To the first corner.

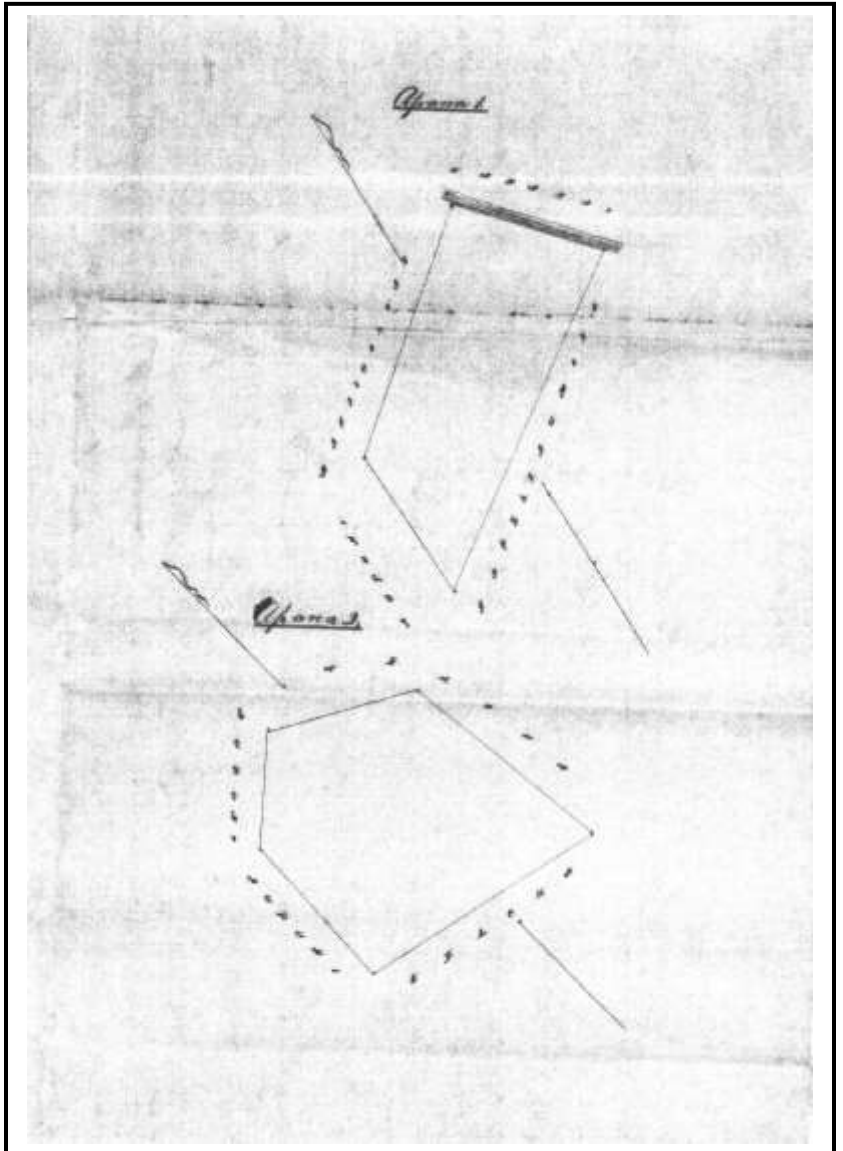

**Figure 3. Notes of Survey for Royal Patent Land Grant
No. 1930 to Nalimakaua at Pawili.
Hawaii State Archives.**

Containing 29. 76/100 Acres.

Parcel 2. Beginning at the far Eastern corner of this parcel, at the place where this parcel joins with the land of Keloha, and running to the:

North $6\frac{1}{4}^{\circ}$ West 455 links adjoining Keloha;
North $62\frac{3}{4}^{\circ}$ West 307 links adjoining Keloha;
South $47\frac{3}{4}^{\circ}$ West 237 links adjoining the Government;
South $2\frac{3}{4}^{\circ}$ West 335 links adjoining the Government;
South $79\frac{1}{4}^{\circ}$ East 525 links adjoining Keloha;
To the corner of commencement.

Containing 2. 20/100 Acres. [Maly, translator]

Lahaina. Nov. 11, 1855.
John Richardson,
Surveyor.

Handwritten header text, possibly a date or reference number.

Faint, mostly illegible handwritten text in the upper middle section.

a maloko o ia Apana *31 1/2* eka a oi iki aku eni iki ma'i paha.
Eia ke kumu o ka lilo ana; ua huawi mai oia iloko o ka waihona waiwai o ke Aupuni i
he 19 1/2
Ako, ua koe i ke Aupuni na mine minerala a me na mine metala a pau.

No
ua aina la i haawiia, no mau loa aku no ma ke ano alodio a no ke mau hoolina, a me
ko waihona, ua pili nso ka auhau a ka Poe Ahaolelo e kau like ni ma na aina alodio a pau i keia
manawa i keia manawa.

A i mea e ike'i, ua kau wau i ko'u inoa, a me ka Sila Nui o ko Hawaii.
Pae Aina, ma Honolulu, i keia la
December, 1857

Handwritten signature: Kamehameha

Handwritten signature: Kamehameha

**Palapala Sila Nui Helu 1931
Makaiholoae**

Aia i loko o ke ahupuaa o Pawili, Mokupuni o Lanai.

E hoomaka ana ma ke kihi Hema o keia e pili ana me ko Nalimakaua, a e holo ana:

Akau 51° Hi. 2160 pauku me Nalimakaua;
 Akau 31 ½ ° Ko. 960 pauku me Kahakai;
 Hema 53 ½ ° Ko. 1546 pauku me Aupuni;
 Hema 5 ½ ° Hi. 1264 pauku me Aupuni.

O kona ili 18. 50/100 Eka.

Lahaina
 Octob. 1855
 John Richardson,
 Mea ana aina.

Translation:

Beginning at the Southern
 corner of this land adjoining
 with Nalimakaua, and
 running:

North 51° East. 2160 links
 along Nalimakaua;
 North 31 ½ ° West 960 links
 along the shore;
 South 53 ½ ° West 1546
 links along the Government
 land;
 South 5 ½ ° East 1264 links
 along the Government land.

Containing 18. 50/100 Acres.

Lahaina
 Oct. 1855
 John Richardson,
 Surveyor. [Maly, translator]

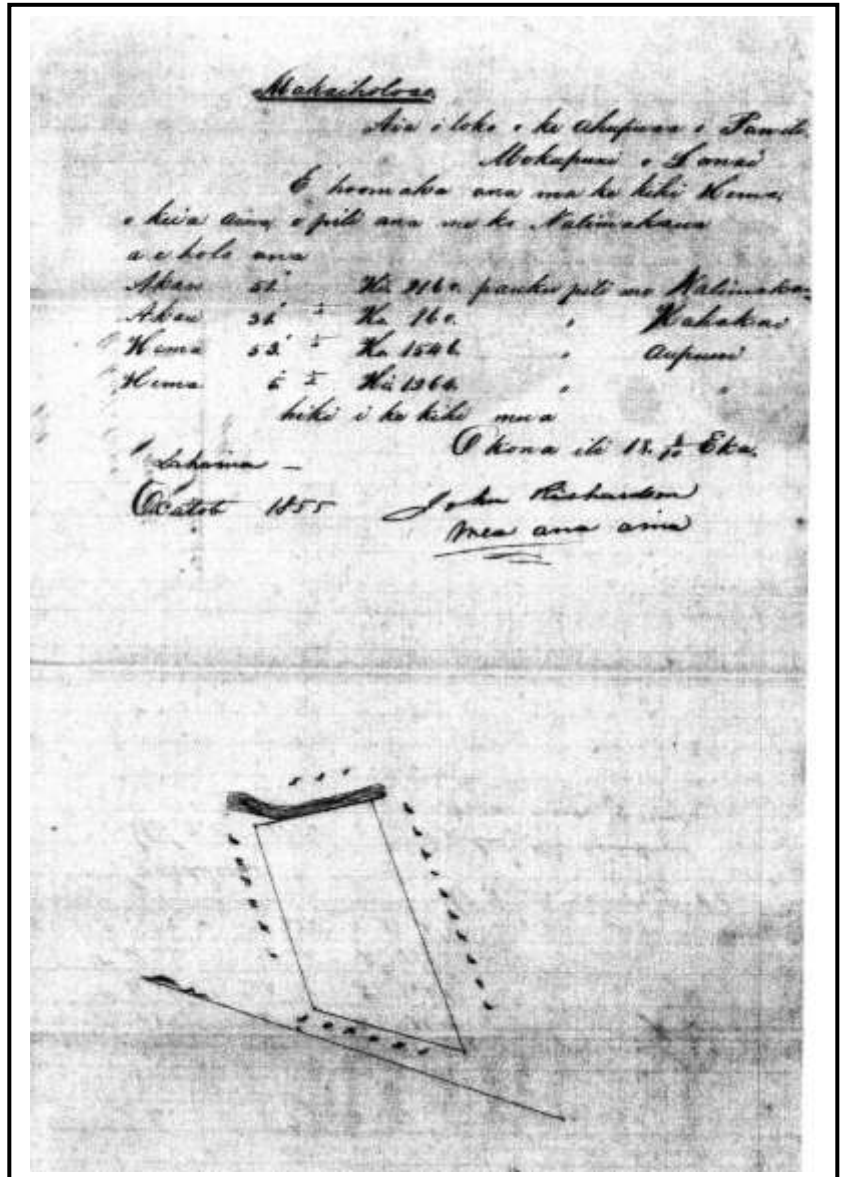

Figure 4. Notes of Survey for Royal Patent Land Grant No. 1931 to Makaiholoae at Pawili. Hawaii State Archives.

HELU 1931 ✓

PALAPALA SILA NUI.

Ma keia Palapala Sila Nui ke buike aku nei o Kamehameha IV., ke Alii nui ā ke Akua i kona lokomaikai i hoonoho ai maluna o ke Hawaii Pae Aina, i na kanaka a pau, i keia la, nona iho, a no kona mau hope Alii, a haawi lilo loa aku oia ma ke ano ulotio la *Makanihohou* i kona *wahi* kanaka i manao pono in la, i keia apana aua a pou o waiho la ma *Kauai* ma ka Moku o *(Lahaina)* ; a penei hoi ka waiho ana o no Moku :

*O Lāhaina aua ma ka wahi Moku a pau aua
o keia aua ma ka Moku aua, a e holo aua*

- Ukaia 51° 41' 31" aua ma ka Moku aua*
- Ukaia 51° 41' 31" aua ma ka Moku aua*
- Ukaia 51° 41' 31" aua ma ka Moku aua*
- Ukaia 51° 41' 31" aua ma ka Moku aua*
- Ukaia 51° 41' 31" aua ma ka Moku aua*

a maloko o in Apana *18th Dec* eka a oi iki aku emi iki ma'i paha.
Eia ke kumu o ka lilo ana; ua haawi mai oia iloko o ka waihona waiwai o ke Aupuni i *ma (pale)*

18th Dec
Aka, ua koe i ke Aupuni na mine minerala a me na mine metala a pau.

No *Mauihohola*
ua aina la i haawia, no *na* mau loa aku no ma ke ano alodio a no *na* mau loolima, a me
ko *na* waihona, ua pili nas ka uuhau a ka Poe Abalelo e kau like ai ma na aina alodio a pua i kela
manawa i keia manawa.

A i mea e ike'i, ua kau wau i ko'u inoa, a me ka Sila Nui o ko Hawaii,
Pae Aina, ma Honolulu, i keia la

December, 1855

Kaahumanu

Kamohamoha

**Palapala Sila Nui Helu 2214
Lonopaawela**

Ahupuaa o Pawili, Mokupuni o Lanai.

E hoomaka ma ke kihi Hikina o keia apana kahi i hui pu ai me Kaunele maluna mai o kekahi wahi ano Loko a e holo ana:

Ak. 60° Kom. 397 pauku me Palawai;
Hik. 31° Kom. 500 pauku me Palawai;
Hik. 28° Kom. 212 pauku me Palawai;
Hik. 31 ½ ° Hik. 225 pauku me Aupuni;
Ak. 27 ½ ° Hik. 200 pauku me Kuaokaulu;
Ak. 57 ½ ° Kom. 128 pauku me Keloha;
Ak. 42 ¼ ° Hik. 362 pauku me Keloha;
Hem. 41° Hik. 184 pauku me Keloha;
Ak. 45 ½ ° Hik. 322 pauku me Kaunele;
hiki i ke kihi mua.

O kona ili 1.64/100 Eka.

Ioane Richardson.
Mea ana aina.

Waikapu.
Nov. 1855.

Translation:

Beginning on the Eastern Corner of this parcel, where it meets with Kaunele, above the place of the Pond, and running:

North 60° West 397 links along Palawai;
East 31° West 500 links along Palawai;
East 28° West 212 links along Palawai;
East 31 ½ ° East 225 links along Government land;
North 27 ½ ° East 200 links along Kuaokaulu;
North 57 ½ ° West 128 links along Keloha;
North 42 ¼ ° East 362 links

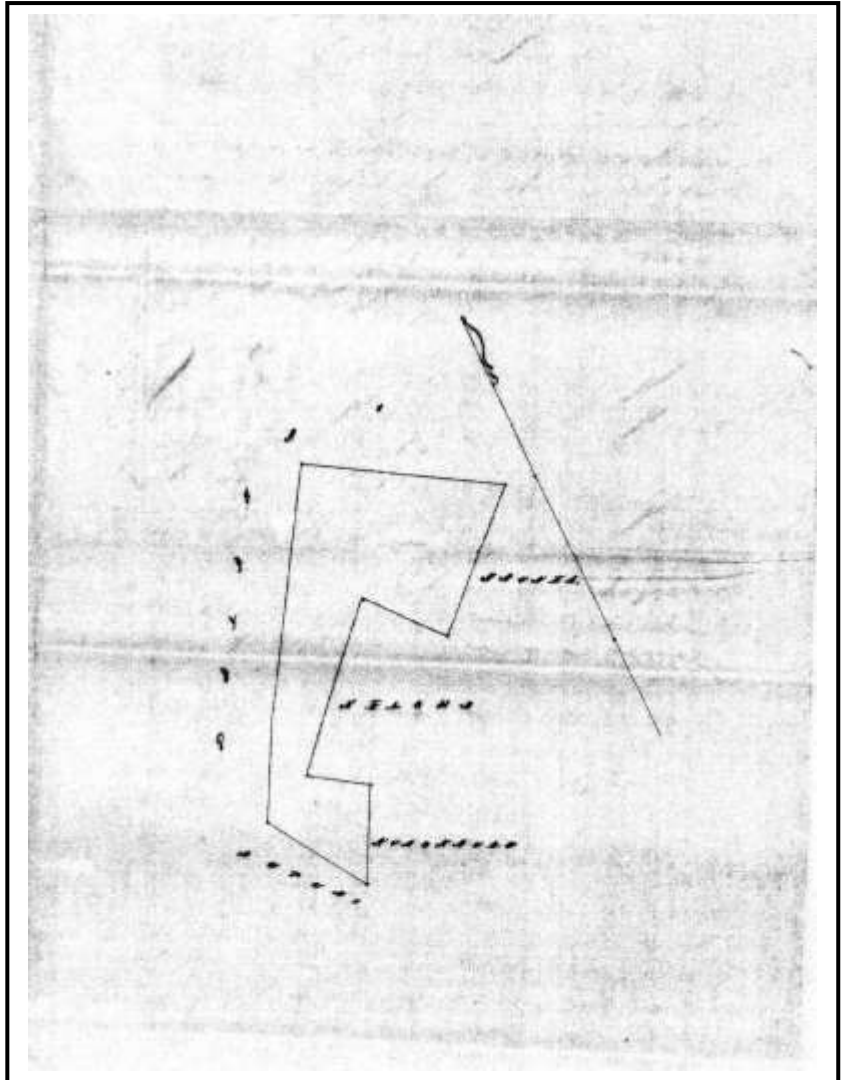

Figure 5. Notes of Survey for Royal Patent Land Grant No. 2214 to Lonopaawela, at Pawili. Hawaii State Archives.

Along Keloha;
South 41° East 184 links along Keloha;
North 45 ½ ° East 322 links along Kaunele;
to the first corner.

Containing 1.64/100 Acres.

John Richardson.
Surveyor.

Waikapu,
Nov. 1855. [Maly, translator]

HELU 2214 ✓

PALAPALA SILA NUI.

Ma keia Palapala Sila Nui ke hoike aku nei o Kamehameha IV, ke Alii Nui a ke Akua i kono Iukemaikai i
hoonoho ai maluna o ko Hawaii Pao Aina, i na kanaka a pau, i keia la, nona iho, a no kona mau hope Alii, ua hawi
hilo loa aku oia ma ke ano alodio ia *Poupaawela*

i kono
kanaka i maeo pono ia ia, i keia apene aia a pau e waiho la ma *Puwili*
ma ka mokupuni o *Lanai*

a penei hoi ke waiho ana o na Mokuna :

*E hoomaka ma ke kiki Kik o kua Kahi i hui pu
me kaunela maluna mai o kekauwahi ano Lohi
Ak. 60. No 397 paut. pili me Palawai*

- ke 31 . 500 .*
- . 28 . 212 .*
- . 312 ke 225 .*
- Ak 27 1/2 . 200 .*
- . 57 1/2 No 128 .*
- . 42 1/2 ke 362 .*
- ke 41 . 104 .*
- Ak 46 1/2 . 322 .*

*Quipuni
Kusokauka
Kalooha*

*Kaunela i ke kiki ma
1/100 Eka.*

Ke ke Kuleana oia Kanaka

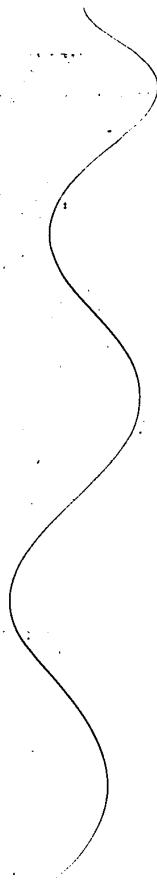

n maloko o ia Apana ¹⁰⁰ eka, a oi iki aku, emi iki mai pahā.
Eia ke kumu o ka lilo ana; ua haawi mai oia iloko o ka waihona waiwai o ke aupuni i *na dala*

¹⁷⁵ Aka, ua koe i ke aupuni nā mine minerala a me na mine metala a pau.

No *Lonopapa* un aina la i haawia, no *na* mau loa aku no, ma ke ano alohio a no ko *na* mau hoolina, a me ko *na* waihona; ua pili nāe ka auhau a ka Poe Ahaolelo e kau like ai ma na aina alohio a pau i kela manawa i keia manawa:

A i mea e ike'a'i, Ua kau wau i ko'u inoa, a me ke Sila Nui o ko Hawaii Pae Aina, ma Honolulu, i keia la *L* o *Pepeluali*, 18 *07*

Kaahumanu

Hammam

**Palapala Sila Nui Helu 2903
Puupai**

Ahupuaa o Pawili & Kealia, Mokupuni o Lanai.

E hoomaka ma he kihi Akau loa
o keia apana i ka waena konu
o kekahi opu Koli nui kihi
Komohana Hema o ko Kaaina
Aina kuai a e holo ana:

He. $14\frac{1}{2}^{\circ}$ Ko. 1620 pauku
me Aupuni;
He. 54° Hi. 3366 pauku me
Aupuni;
Ak. $21\frac{1}{4}^{\circ}$ Hi. 1512 pauku me
Aupuni;
Ak. $50\frac{1}{2}^{\circ}$ Ko. 970 pauku me
Kapahoa;
Ak. $54\frac{3}{4}^{\circ}$ Ko. 2606 pauku me
Kaaina;
Hiki i kahi hoomaka ai.

O kona ili 52.07/100 Eka.

[John Richardson]
Waikapu
Nov. 1855.

Translation:

Beginning at the far Northern
corner of this parcel, in the
middle of a large clump of
Castor plants, at the South
Eastern corner of land
Purchased by Kaaina, and
running:

South $14\frac{1}{2}^{\circ}$ West 1620 links
along Government land;
South 54° East 3366 links
along Government land;
North $21\frac{1}{4}^{\circ}$ East 1512 links
along Government land;
North $50\frac{1}{2}^{\circ}$ West 970 links
along Kapahoa;
North $54\frac{3}{4}^{\circ}$ West 2606 links
along Kaaina.

52.07 Acres. [Maly, translator]

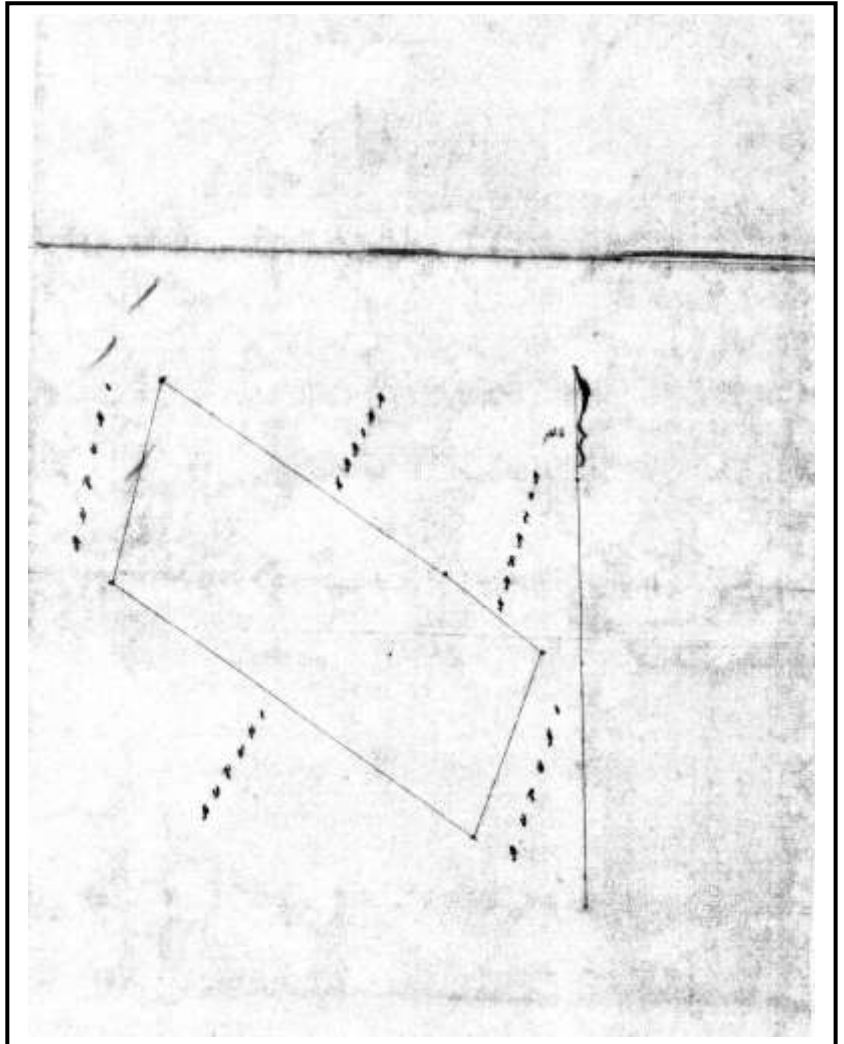

**Figure 6. Notes of Survey for Royal Patent Land Grant
No. 2903 to Puupai, at Pawili & Kealia
Aupuni. Hawaii State Archives.**

Handwritten text at the top of the page, possibly a title or date.

Main body of handwritten text, mostly illegible due to fading and bleed-through.

a ma'oko o ia Apana *1863* eka a oi iki aku eia iki ma' paha.
 Eia ke ku'ou o ka Ijo au; ua haawi mai oia iloko o ka wailona waiwai o ke Aupuni i
na hale o 1863
 Aka, ua koe i ke Aupuni na mine minerala a me na mine metala a pau.
 No *Pu'upai*
 ua nina la i haawilo, *nona* mau loa aku no, ma ke ano alo'io a no koma mau hoo'io, a me ko
na wailona, ua pii nne ka auhau a ka Poe Aheolelo e kau like ai ma na nina alo'io a pau i kela
 manawa i keia manawa.

A i mea e ike'a'i, ua kau wau i ko'u inoa, a me ka Sila Nui o ko Hawaii I'ao Aina,
 ma Honolulu, i keia la *29* o *Wanuwani*, 1863

Kiaakumana
Kamehameha
Kamehameha

**Palapala Sila Nui Helu 2971
Kapahoa**

Apana Aina Aupuni ma Pawili Mokupuni o Lanai

E hoomaka i ke ana ma ke kahi Hikina Akau mauka o keia, ma ka lihi Komohana o ke kahawai e pili ia ai keia aina me Palawai ma ka puu pohaku ma ka pohaku Hoailona ia X. A holo Hem. 14° Kom. 16 66/100 kaul. mawaena o na Pohaku e moku ana i ke alanui a me ke kahawai a i ka lihi Kom. o ke Alanui; holo i kai ma ka pohaku X, alaila huli; Hem. 36° Kom. 23 90/100 Kaul; alaila Ak. 61° 30' Kom. 7 83/100 Kaul. i ke kahi Hema o ko Kaaina, huli Ak. 32° Hik. 38 Kaul. ma ko Kaaina a i ka pali; alaila, Hem. 78° Hik. 5 Kaul. hiki i ke kahi i hoomaka'i.

Malaila 33 Eka.
Anaia 16, Oct. 1863
J.W. Makalena
Ana Aina

Translation:

Beginning at the North Eastern corner, above here, on the Western edge of the gulch adjoining this land at Palawai, at a stone outcrop, a stone Marked X. Running South 14° West 16 66/100 Chains, breaking through the stones, the trail and the gulch, on the Western side of the Trail; running shoreward to the stone X; then turning South 36° West. 23 90/100 Chains, then North 61° 30', West 7 83/100 Chains, to the Southern corner of Kaainas' land; turn North 32° East 38 Chains, along Kaainas' land to the cliff; then South 78° East 5 Chains to the corner of commencement.

There being 33 Acres.
Survey Oct. 16, 1866. J.W. Makalena, Surveyor. [Maly, translator]

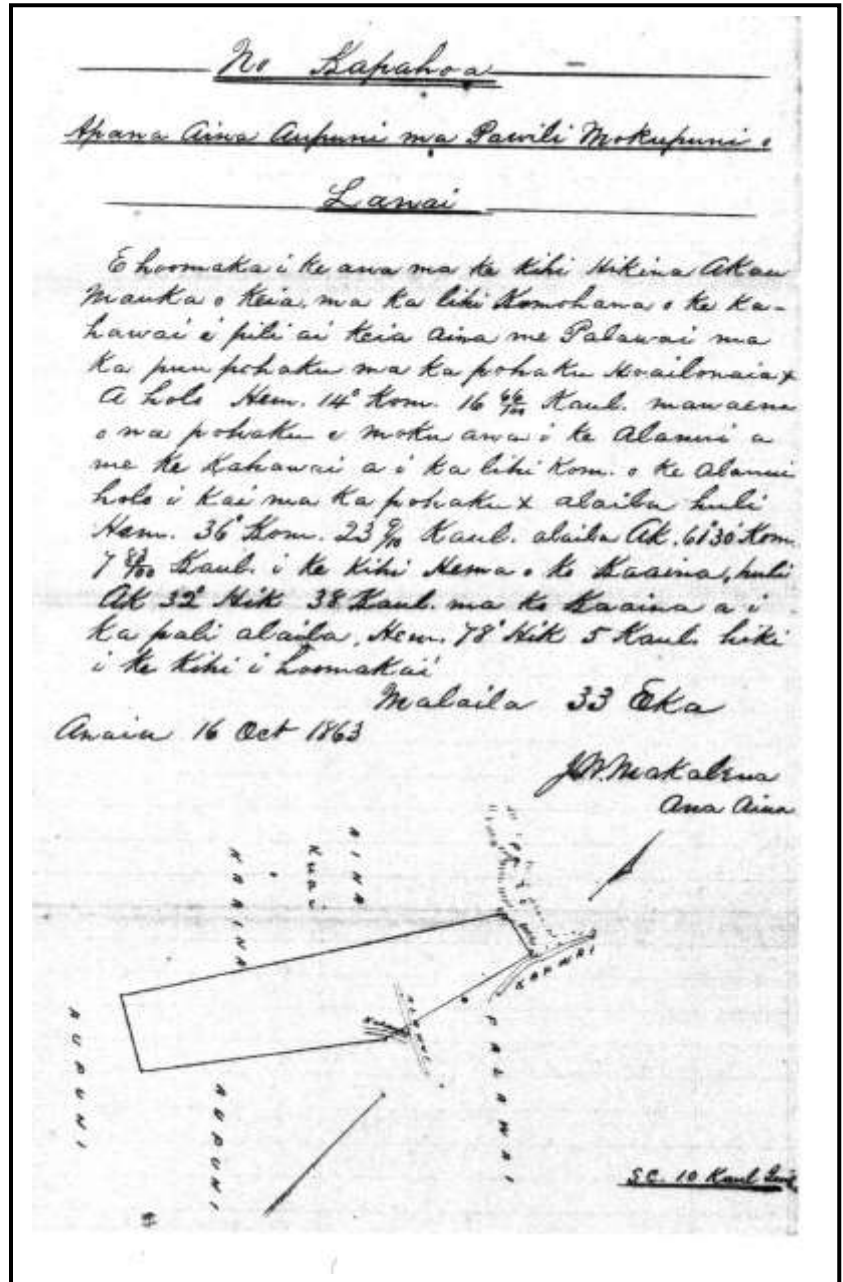

Figure 7. Notes of Survey for Royal Patent Land Grant No. 2971 to Kapahoa, at Pawili. Hawaii State Archives.

HELU 2971 ✓
PALAPALA SILA NUI.

Ma keia Palapala Sila Nui ke hūke aku nei o Kamehameha IV., ke Alii nui a ke Akua i kona lōkomaikai
i hongolo ni muluna o ka Hāiwaii Pae Aina, i na kanaka a pū, i keia la, noua iho, a no kona mau hope Alii,
na hanwi lilo loa aku oia ma ke ano aloha i
i kona *Kapahoa* kanaka i inuao pono ia ia, i kela nōna aia a
pae e waiho ia ma *Pawili* apanai
- ma ka Moku o *Panai* ; a penei hūi ka waiho ana o na Moku:

*E koomaka i ke ana (ma ke Ahii) Keia. Ma mauia i keia
ma ke Ahii. Keia o ke Ahiiwai i pili ai. Keia ana
ma Palawai ma ka Pae pohaku (ma ka pohaku kōnōnō
a hōlo Keia i Keia. 16.66 Chaul (ma ana o ke pohaku
e motu ana i ke alani a ma ke Ahiiwai. a. ka hōlo
Keia. o ke alani hōlo: Keia ma ke pohaku + alani
Keia. 56. Keia. 23 1/2 Chaul - Keia. 61. 30 Keia. 7. 83 hōlo.
i ke Ahii Keia. o ke Keia. hōlo) Keia. 32 Keia. 28
Keia (ma ke Keia a i ke Keia, alani Keia 78 Keia
5. Chaul, hōlo) i ke Ahii i koomaka
33 Keia
Keia (ma ke Keia o na Keia)*

a maloko o ia Apana ————— 23 ————— eka a oi iki aku emi iki mai paha.
Eia ke kumu o ka lilo ana; ua hawi mai oia iloko o ka waihona waiwai o ke Aupuni i *ka hale*

Ke 33.
Ako, ua koo i ke Aupuni na mine minerala a mo na mine metala a pau.

No *Ke Aupuni*
ua nina ia i hawila, no *na* mau loa aku no, ma ke ano alodio a no ko *na* mau hooilina, a me ko
na waihona, ua pili nzo ka aohou a ka Poe Ahaolelo e kuu like ai ma na nina alodio a pau i kela
manawa i'keia manawa.

A i mea e ika'i, un kuu wnu i ko'u inoa, a mo ka Sila Nui o ho Hawaii I'ae Aina,
ma Honolulu, i keia la *24* o *Augato*, 18*64*

By the King
C. G. King

Chamshamcha R.

**Palapala Sila Nui Helu 3029
Nahuina & Keliuhue**

**Apana 1. Ma ke Ahupuaa o
Kalulu, Mokupuni o Lanai.**

E hoomaka ana ma ke kihi
Komohana Hema o keia apana
a holo aku i ka:

He. $52 \frac{1}{2}^{\circ}$ Hi. 2532 pauku
pili me Aupuni;
Ak. 52° Hi. 2653 pauku
pili me Aupuni;
Ak. $43 \frac{3}{4}^{\circ}$ Ko. 2030 pauku
pili me Aupuni;
He. $30 \frac{1}{4}^{\circ}$ Ko. 514 pauku
pili me Ahupuaa o Kamoku;
He. $53 \frac{3}{4}^{\circ}$ Ko. 718 pauku
pili me Ahupuaa o Kamoku;
He. $68 \frac{1}{2}^{\circ}$ Ko. 2930 pauku
pili me Ahupuaa o Kamoku;
He. $45 \frac{1}{2}^{\circ}$ Ko. 2080 pauku
pili me Ahupuaa o Kamoku;
Hiki i ke kihi mua.
O kona ili $133 \frac{1}{10}$ Eka.

**Apana 2. Ma ka ili o
Kaumalapau i loko o
ke Ahupuaa o Kamoku.**

E hoomaka ana ma ke kihi
Hikina Akau o keia apana
a holo aku i ka:

Ak. $52 \frac{3}{4}^{\circ}$ Ko. 415 pauku
pili me Aupuni;
Ak. 44° Ko. 2144 pauku
pili me Malulu;
He. $32 \frac{1}{2}^{\circ}$ Ko. 4664 pauku
pili me Malulu;
He. 43° Hi. 2320 pauku
pili e Aupuni;
Ak. 29° Hi. 2540 pauku
pili me Ili o Pueo;
Ak. 43° Hi. 2200 pauku
pili me Ili o Pueo;
Hiki ke kihi i hoomaka ai.
O kona ili, $103. \frac{58}{100}$ Eka.

[John Richardson]

Waikapu.
Nov. 1855.

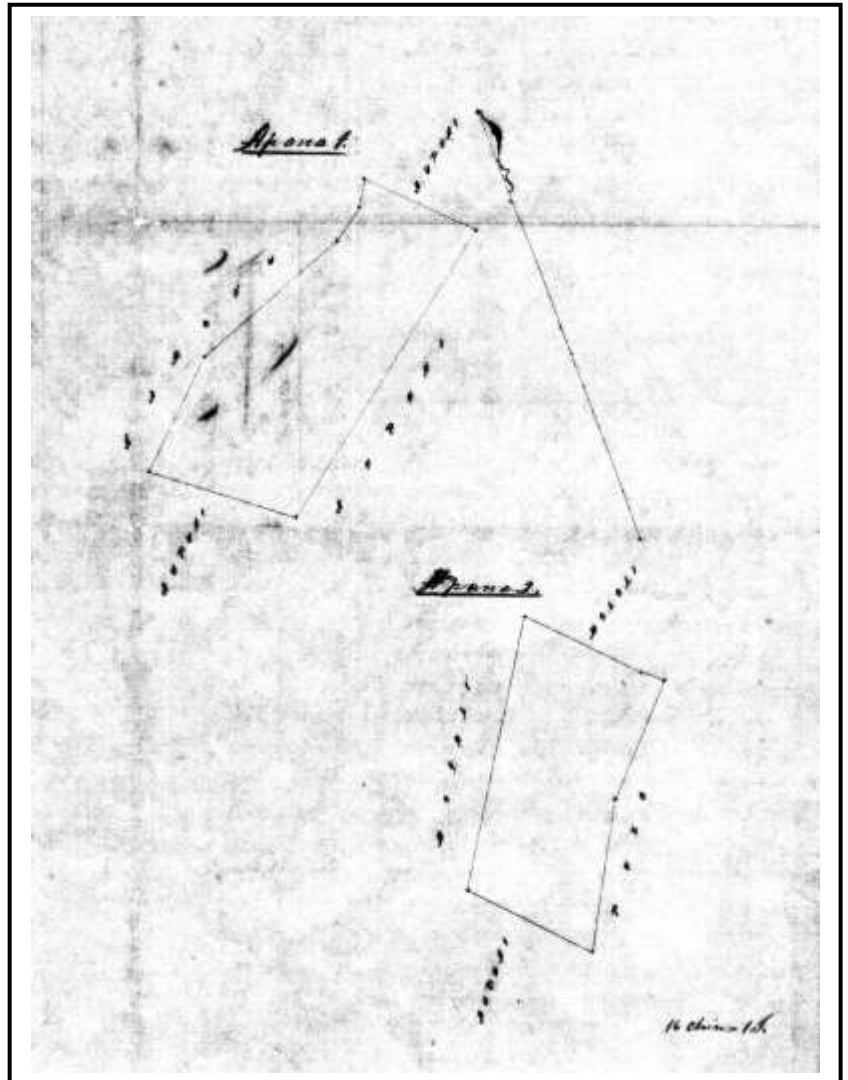

**Figure 8. Notes of Survey for Royal Patent Land Grant
No. 3029 to Nahuina & Keliuhue, at Kalulu and
Kamoku. Hawaii State Archives.**

Translation:

Parcel 1. In the Ahupuaa of Kalulu, Island of Lanai.

Beginning at the Southwestern corner of this parcel and running to the:

South $52 \frac{1}{2}^{\circ}$ East 2532 links along Government;
North 52° East 2653 links along Government;
North $43 \frac{3}{4}^{\circ}$ West 2030 links along Government;
South $30 \frac{1}{4}^{\circ}$ West 514 links along the Ahupuaa of Kamoku;
South $53 \frac{3}{4}^{\circ}$ West 718 links along the Ahupuaa of Kamoku;
South $68 \frac{1}{2}^{\circ}$ West 2930 links along the Ahupuaa of Kamoku;
South $45 \frac{1}{2}^{\circ}$ West 2080 links along the Ahupuaa of Kamoku;
To the first corner.

Containing 133 $\frac{1}{10}$ Acres.

Parcel 2. In the ili of Kaumalapau, in the Ahupuaa of Kamoku.

Beginning at the Northeastern corner of this parcel and running to the:

North $52 \frac{3}{4}^{\circ}$ West 415 links along Government;
North 44° West 2144 links along Malulu;
South $32 \frac{1}{2}^{\circ}$ West 4664 links along Malulu;
South 43° East 2320 links along Government;
North 29° East 2540 links along the Ili of Pueo;
North 43° East 2200 links along the Ili of Pueo;
To the corner of commencement.

Containing 103 $\frac{58}{100}$ Acres.

[John Richardson]

Waikapu.

Nov. 1855. [Maly, translator]

HELU 3029 ✓
PALAPALA SILA NUI.

Ma keia Palapala Sila Nui ke hoike aku nei o Kamehameha IV., ke Ali nui a ke Akua i kona lokomaikai i hoonoho ni malama o ko Hawaii Pae Aiea, i na kanaka a pau, i keia la, nona iho, a no kona mau hope Alii, ma hanawi lilo loa aku oia ma ke ano alogio ia *Nahina & Kolihue* i kona kanaka i mauo pono ia ia, i keia upuna aia a pau e waiho la ma *M.P. Kalulu* ma ka Moku oia *(Onaia)*; a penei hoi ka waiho ana o na Moku:

Ekoomaka ma ka (Kih) Kom. Kona. aia
Kama 53 1/2 (K) 2532 (ma ka) (Apunui)
Mau 52 " 5653 " " "
" 43 1/2 (K) 2030 " " "
Kama 30 1/2 " 514 " " (M.P. Kama)
" 53 1/2 " 718 " " "
" 68 1/2 " 2930 " " "
" 45 1/2 " 2080 " " "

133.10 (Ka)

Apunui - M. Kamaulapaia iho o Kamaulapaia
Ekoomaka ma ka (Kih) Kona. aia
Mau 52 1/2 (K) 415 (ma ka) (Apunui)
" 44 " 2144 " " (Kolohe)
Kama 53 1/2 " 4664 " " "
" 43 (K) 2320 " " (Apunui)
Mau 29 " 2540 " " (K. Pae)
" 43 1/2 " 2200 " " "

103.58 (Ka)

Ko ka Kuleana o na Kamaulapaia

[Faint, mostly illegible handwritten text, possibly bleed-through from the reverse side of the page.]

a maloko o ia Apana *236.68* eka a oi iki aku emi iki mai paha.
 Eia ke kumu o ka lilo ana; ua haawi mai oia iloko o ka waihou waiwai o ke Aupuni i *ka lilo*
236.75
 Aka, na koe i ke Aupuni na mine minerals a ioo na mine metala a pau.
 No *Nahaina C. Kelihue*
 ua nina la i haawia, no *Sam* mau loa aku no, ma ke mo alohia a no ko *hua* mau hoolina, a me ko
hana waihou, ua pili me ka mahau a ka Poe Ahaololo e kau like ai ma na aina alohia a pau i kela
 mauwa i keia mauwa.

A i mea e ikeai, ua kau wau i ko'u iooa, a me ka Sila Nui o ko Hawaii I'ao Aiea,
 ma Honolulu, i keia la *12* o *September*, 18*66*

By the King
(F.W. Hutchinson)

Ronaldamela R.

**Palapala Sila Nui Helu 3030
Kapeleaumoku**

Aia ma ke Ahupuaa o Pawili Mokupuni o Lanai

E hoomaka ma ke kahi Hema e pili ana i ko Kekua, a e holo ana:

Akau 54 ¼ ° Hi. 2,400 pauku pili me Kekua;
 Akau 46 ½ ° Ko. 1,220 pauku pili me Kahakai;
 Hema 55° Ko. 3,000 pauku pili me Nalimakaua;
 Hema 70° Hi. 1,460 pauku pili me Apuni.

O kona ili 32 6/100 Eka.

[John Richardson]

Lahaina
 Octob. 1855.

Translation:

Starting at the Southern corner Adjoining Kekua, and running:

North 54 ¼ ° East 2400 links adjoining Kekua;
 North 46 ½ ° West 1220 links along shore;
 South 55° West 3000 links along Nalimakaua;
 South 70° East 1460 links along Government land.

Containing 32 6/100 Acres.

[John Richardson]

Lahaina
 Octob. 1855. [Maly, translator]

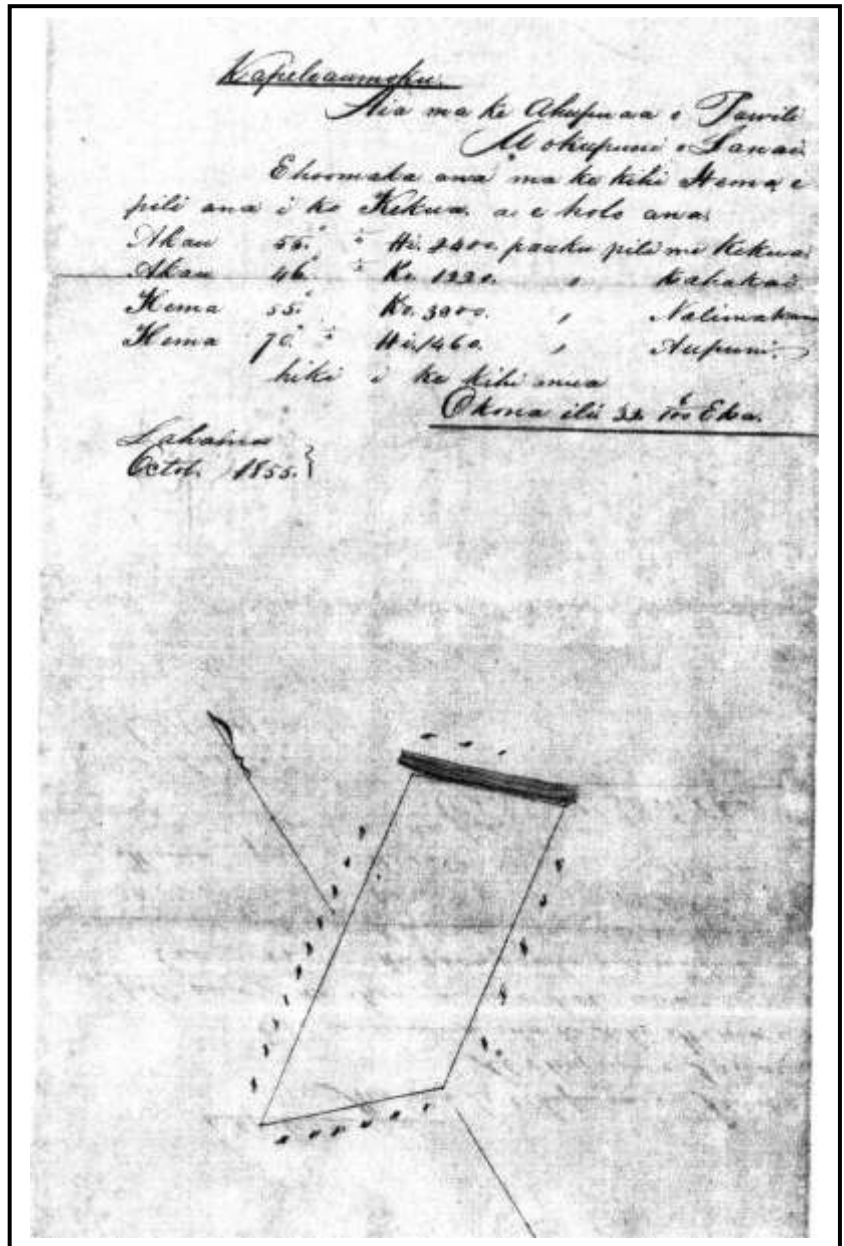

Figure 9. Notes of Survey for Royal Patent Land Grant No. 3030 to Kapeleaumoku, at Pawili. Hawaii State Archives.

HELU 3030

PALAPALA SILA NUI.

Ma keia Palapala Sila Nui ke ha'ike aku nei o Kamehameha IV., ke Alii nui a ke Akua i kona lokomaikai i huonohu ai maluna o ke Hawaii Pae Aina, i na kanaka a pau, i keia la, nona iho, a no kona mau hope Alii, ua hana iho loa aku oia ma ke ano aloha ia *Olafaleamoku* i kona kanaka i maha pono ia ia, i keia apuna aia a pau e waiho ia ma.

na ka Moku o *Paele* *Lana'i* ; a penei hoi ka waiho ana o na Moku:

<i>Ohoomaka</i>	<i>Ma</i>	<i>ke</i>	<i>Hiki</i>	<i>Alua</i>	<i>ma</i>	<i>ke</i>	<i>Kehua</i>
<i>Man</i>	<i>55</i>	<i>HR</i>	<i>2,400</i>	<i>Pante</i>	<i>ma</i>	<i>ke</i>	<i>Hakua</i>
<i>"</i>	<i>46 1/2</i>	<i>HR</i>	<i>1,220</i>	<i>"</i>	<i>"</i>	<i>"</i>	<i>Kahakui</i>
<i>Alua</i>	<i>55</i>	<i>"</i>	<i>3,000</i>	<i>"</i>	<i>"</i>	<i>"</i>	<i>Kalimatano</i>
<i>"</i>	<i>70</i>	<i>HR</i>	<i>1,460</i>	<i>"</i>	<i>"</i>	<i>"</i>	<i>Amuani</i>
							<i>32.06 Pae</i>

Ma ke Kuleana o na Kanaka

ROYAL PATENT GRANTS

[Faint, mostly illegible handwritten text, likely the main body of the patent grant.]

a maloko o ia Apana _____ \$2.06 _____ eka a oi iki aku eui iki mai paha.
 Eia ke kumu o ka lilo nua; ua haawi mai oia iloko o ka waihona waiwai o ke Aupuni i *ka Data*
ke \$2.02
 Aka, ua koe i ke Aupuni na mine puineraha a mo na mine metala a pau.
 No *alapele aumotu*
 ua aiaa la i haawi, no *na* mau loa aku no, ma ke ano alodio a no ko *na* mau hoolina, a me ko
na waihona, ua pili nae ka auhau a ka Poe Aliaolelo e kau like ai ma na aiaa alodio a pau i kela
 manawa i keia manawa.

A i nua e ika'i, ua kau wau i ko'u inoa, a me ka Sila Nui o ko Hawaii I'ao Aina,
 ma Honolulu, i keia la *12* o *September* 1866, 18

By the King
(J.M. Bulchison)

Kamehameha III.

**Palapala Sila Nui Helu 3031
Kaaina**

Ma ke Ahupuaa o Kaunolu, Mokupuni o Lanai.

E hoomaka ma ke kihi Hikina o keia apana ma kekahi kumu kukui kahi i hui ai me Kapahoa aina kuai, a e holo ana i ka:

Ak. $56 \frac{1}{2}^{\circ}$ Ko. 2544 pauku
me Aupuni;
He. $37 \frac{1}{2}^{\circ}$ Ko. 584 pauku
hiki i ke Alanui Aupuni;
He. $39 \frac{1}{2}^{\circ}$ Ko. 3230 pauku
me Aupuni;
He. $54 \frac{3}{4}^{\circ}$ Hi. 2606 pauku
me Puupai;
Ak. 38° Hi. 3900 pauku
me Kapahoa;
hiki i ke kihi mua.

O kona ili 99. 7/100 Eka.

[John Richardson]

Waikapu.
Nov. 1855.

Translation:

Beginning at the Eastern
corner of this parcel, at a
Kukui tree, adjoining the land
purchased by Kapahoa, and
running to the:

North $56 \frac{1}{2}^{\circ}$ West 2544 links
along Government;
South $37 \frac{1}{2}^{\circ}$ West 584 links
to Government Road;
South $39 \frac{1}{2}^{\circ}$ West 3230 links
along Government;
South $54 \frac{3}{4}^{\circ}$ East 2606 links
along Puupai;
North 38° East 3900 links
along Kapahoa;
to the first corner.

Containing 99. 7/100 Acres.

[John Richardson]

Waikapu
Nov. 1855. [Maly, translator]

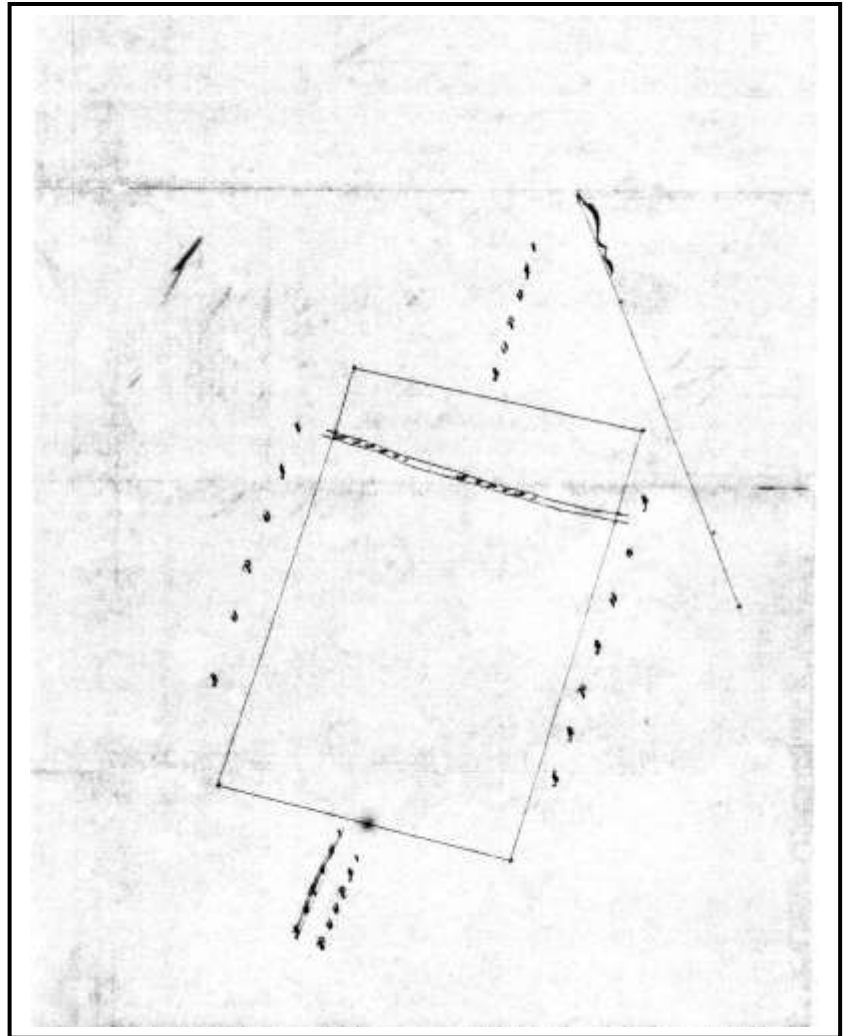

**Figure 10. Notes of Survey for Royal Patent Land
Grant No. 3031 to Kaaina, at Kaunolu.
Hawaii State Archives.**

HELU 3031 ✓

PALAPALA SILA NUI.

Ma keia Palapala Sila Nui ke hoike aku nei o Kamehameha IV., ke Alii nui a ke Akua i kona iukomunikai i hoonoho ni malama o ko Hawaii Pae Aina, i na kanaka a pou, i keia la, nona iho, a no kona inau hope Alii, na hanwi lilo loa aku oia ma ke ano alodio ia *(Koaia)*

i kona kanaka i inauo pono ia ia, i keia apuna aina a pou e waiho la ma *(Ke Aup. o Kaula)* ma ka Mokupuni o *(Punai)*; a penei hoi ka waiho ana o na Mokuna:

(Ehoonaha) (Ma oke Kahi) (A) ma kahi kuma Kahi (Kahi) i hui ai (me) to (Kapa) (aina) Kua.

Manu 56 1/2 Non 2544 Paila ma oke (Kupuni)

Kama 57 1/2 " 584 " " (Kauai)

" 57 1/2 " 2230 " " (Kupuni)

" 54 1/2 (A) 2606 " " (Punai)

Manu 58 " 2900 " " (Kapa)

99.07 (A)

Koe ka (Kapa) o na Kanaka

[Faint, mostly illegible text, possibly bleed-through from the reverse side of the page]

a maloko o ia Apana 99.07 eka a oi iki aku emi iki nui pala.
 Eia ke kumu o ka lilo ana; ua haawi mai oia hoko o ka waihona waiwai o ke Aupuni i
Ma'ala ke 99.12
 Aka, ua koo i ke Aupuni na mine minerala a me na mine metala a pau.
 No *Ka'aina*
 ua aina la i haawilo, no na mea loa aku no, ma ke ano alodio a no ko *na* mau hoolina, a me ko
 na waihona, ua pili nae ka aulau a ka Poe Ahaolelo e kau like ai ma na aina alodio a pau i kela
 manawa i keia manawa.

A i nua e ika'i, ua kau wau i ko'u inoa, a me ka Sila Nui o ko Hawaii Pae Aina,
 ma Honolulu, i keia la *12* o *Septemba* 1866, 18

By the King
W. W. Patterson

Kamehameha R.

**Palapala Sila Nui Helu 3032
Pali**

Ma ke Ahupuaa o Kaunolu Mokupuni o Lanai

E hoomaka ana ma ke kihi Hikina loa o keia apana e pili ana i kahakai he Kanalima pauku mai ka pili kai mai i ka wa kai emi a hiki i ke kihi hoomaka a e holo ana:

Ak. $57\frac{1}{4}^{\circ}$ Ko. 7.44 pauku, pili me kahakai;
He. 38° Ko. 697 pauku, pili me Keamo & Kalaniwahine;
Ak. 49° Ko. 863 pauku, pili me Keamo & Kalaniwahine;
He. 28° Ko. 14.00 pauku, pili me Keamo;
He. 55° Hi. 1212 pauku, pili me Aupuni;
He. $71\frac{1}{4}^{\circ}$ Hi. 485 pauku, pili me Aupuni;
Ak. $39\frac{1}{2}^{\circ}$ Hi. 723 pauku, pili me Aupuni;
Ak. 23° Hi. 1194 pauku, pili me Nahula;
Hiki i ke kihi mua.

O kona ili 29 $\frac{6}{100}$ Eka.

[John Richardson]

Waikapu
Nov. 1855.

Translation:

Beginning at the far Eastern corner of this parcel, along the shore, fifty links from the waters edge at low tide to the beginning corner, and running:

North $57\frac{1}{4}^{\circ}$ West 7.44 links along the beach;
South 38° West 697 links, along Keamo & Kalaniwahine;
North 49° West 863 links, along Keamo & Kalaniwahine;
South 28° West 14.00 links, along Keamo;
South 55° East 1212 links, along the Government land;
South $71\frac{1}{4}^{\circ}$ East 485 links, along the Government land;
North $39\frac{1}{2}^{\circ}$ East 723 links, along the Government land;
North 23° East 1194 links, along Nahula;
To the first corner.

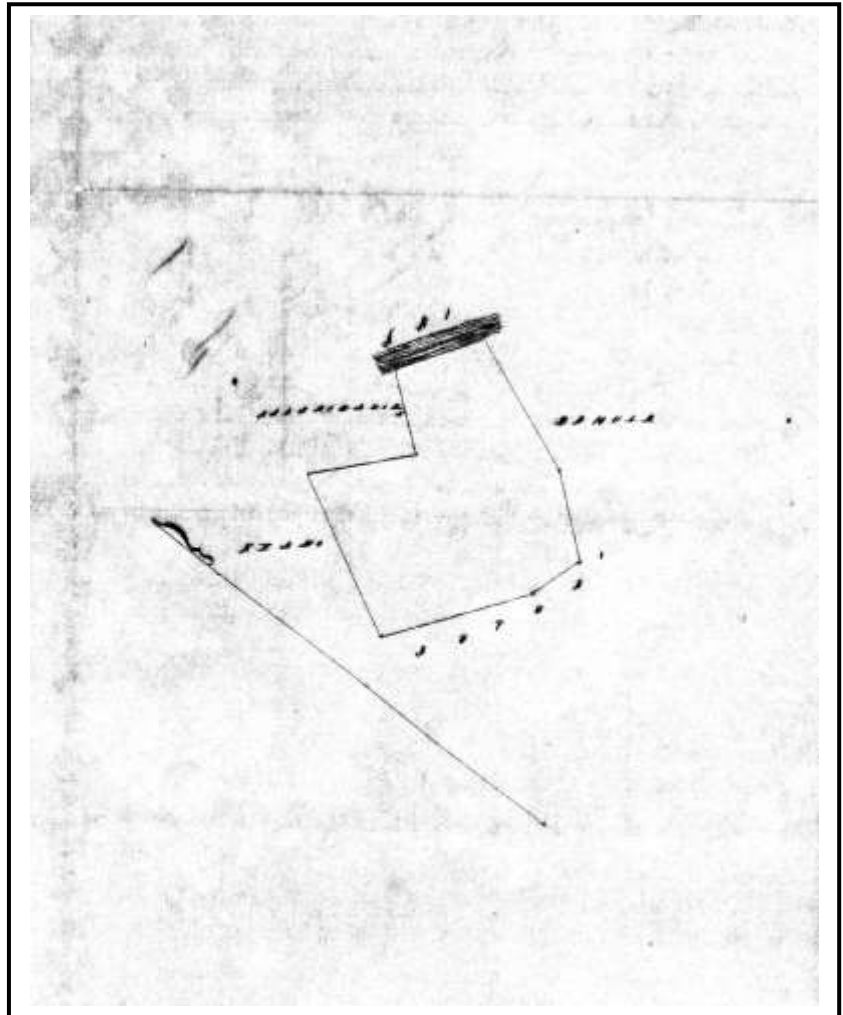

Figure 11. Notes of Survey for Royal Patent Land Grant No. 3032 to Pali, at Kaunolu. Hawaii State Archives.

Containing 29 6/100 Acres.

[John Richardson]

Waikapu

Nov. 855. [Maly, translator]

HELE 3032
PALAPALA SILA NUI.

Ma keia Palapala Sila Nui ke hoike aku nei o Kamehameha IV., ke Alii nui a ke Akua i kona lokomika
i honoho ai malua o ke Hiiwaii Pae Aina, i na kanaka a pau, i keia ka, nona iho, a no kona mau hope Alii,
na hanwi filo loa aku oia ma ke ano aloho ia *Pole*
i kona *Kaunohi* kanaka i mana pono ia ia, i kela upua aina a
pau e waiho ia ma *Lana'i* na ka Mokupuni o *Lana'i*; a penci hoi ka waiho ana o na Mokuna:

*Hoomaka ma eke (Stiki) (Kik) (Pik) ana; kahatai
ke Kawale (ma pauka) (mai) ka pika (Kai) (Kini) (Kewu)
Kai emi a hiki; ke (Stiki) hoomaka e holo
Man 57; Kono 744 route ma Kahatai
Kono 58 " 697 " " Kono & Kalamoihine
Man 49 " 863 " " "
Kono 28 " 1400 " " Kono
" 55 (Kik) 1212 " " (Kupuni)
" 71 485 " " "
Man 39 722 " " "
" 23 " 1194 " " (Kahala)
29.06 (Ka)
Koe ke (Kulana) o na Kanaka*

1855 A 322 1 1866 J A 3

... ..

[Faint, mostly illegible handwritten text]

n muloko o ia Apana 39.06 eka a oi iki aku emi iki mai paha.
Eia ke kumu o ka lili ana; ma haawi mai oia iloko o ka waihoia waiwai o ke Aupuni i

no data ke 39.06
Aka, ua koe i ke Aupuni na mine minerala a me na mine metala a pau.

No *Pali*
ua aina la i haawia, no *ka* mau loa aku no, ma ke ano alodio a no ko *na* mau hoolina, a me ko
ka waihoia, ua pili nae ka anahu a ka Poe Ahaolele e kau like ni ma na aina alodio a pau i kela
manawa i keia manawa.

A i mea e ike'i, ua kau wau i ko'u inoa, a me ka Sila Nui o ko Hawaii I'ao Aina,
ma Honolulu, i keia la *12* o *September 1866*, 18

*By the King
L. W. Patterson*

Ramchamcha

**Palapala Sila Nui Helu 3033
Keamo**

Ma ke Ahupuaa o Kaunolu, Mokupuni o Lanai.

Apana 1.—E hoomaka ana ma ke kihi Hikina o keia apana kahi i hui ai me Pali a me Kalaniwahine, a e holo aku i ka:

He. 28° Ko. 1400 pauku me Pali;
Ak. 36 $\frac{1}{4}$ ° Ko. 662 pauku me Aupuni;
Ak. 52 $\frac{1}{2}$ ° Ko. 950 pauku me Aupuni;
Ak. 35 $\frac{3}{4}$ ° Hi. 1082 pauku me Napuulu;
Ak. 72 $\frac{3}{4}$ ° Hi. 290 pauku me Napuulu;
He. 52 $\frac{1}{2}$ ° Hi. 388 pauku me Kalaniwahine;
Ak. 39 $\frac{3}{4}$ ° Hi. 326 pauku me Kalaniwahine;
He. 54 $\frac{1}{2}$ ° Hi. 133 pauku me Kahakai;
He. 38 $\frac{1}{2}$ ° Ko. 514 pauku me Kalaniwahine;
He. 49° Hi. 700 pauku me Kalaniwahine;
hiki i ke kihi mua.

O kona ili 20.1/10 Eka.

Apana 2. ma Kaunolu.
E hoomaka ma ka kihi Hikina o keia apana kahi i hui ai me Pali ma Kahakai, a e holo ana:

He. 38° Ko. 100 pauku pili me Pali;
Ak. 52° Ko. 1555 pauku pili me Kalaniwahine.
Alaila holo aku ma ke kahakai a hiki i ke kihi mua.

O kona ili 0.75/100 Eka.

[John Richardson]

Waikapu
Nov. 1855.

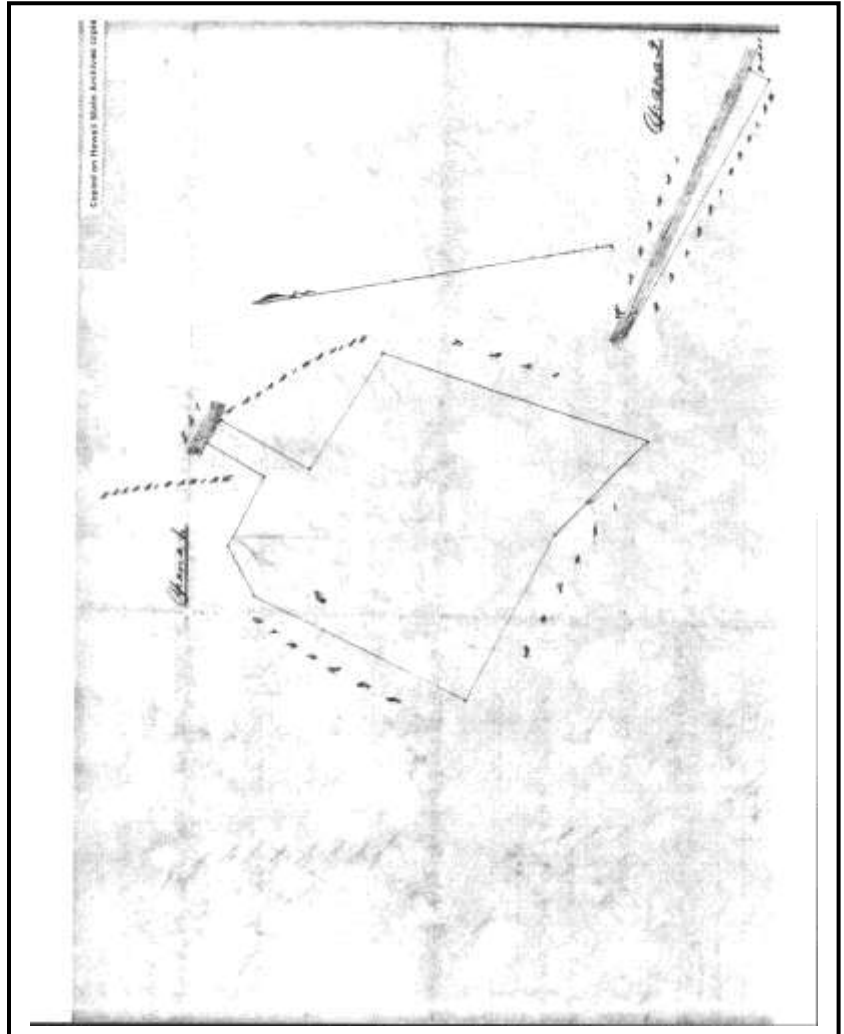

Figure 12. Notes of Survey for Royal Patent Land Grant No. 3033 to Keamo, at Kaunolu. Hawaii State Archives.

Translation:

Parcel 1. Beginning at the Eastern corner of this parcel, where it meets with Pali and Kalaniwahine, and running to the:

South 28° West 1400 links along Pali;
North 36 ¼ ° West 662 links along Government;
North 52 ½ ° West 950 links along Government;
North 35 ¾ ° East 1082 links along Napuulu;
North 72 ¾ ° East 290 links along Napuulu;
South 52 ½ ° East 388 links along Kalaniwahine;
North 39 ¾ ° East 326 links along Kalaniwahine;
South 54 ½ ° East 133 links along Shore;
South 38 ½ ° West 514 links along Kalaniwahine;
South 49° East 700 links along Kalaniwahine;
to the first corner.

Containing 20. 1/10 Acres

Parcel 2. At Kaunolu.

Beginning at the Eastern corner of this parcel, where it adjoins Pali and the Beach, and running:

South 38° West 100 links along Pali;
North 52° West 1555 links along Kalaniwahine;
Then running along the beach to the first point.

Containing 0.75/100 Acre.

[John Richardson]

Waikapu
Nov. 1855. [Maly, translator]

HELE 3033
PALAPALA SILA NUI.

Ma keia Palapala Sila Nui ke hoike aku nei o Kamehameha IV., ke Alii nui a ke Akua i kona lokomaikai i hoonoho ai maluna o ko Huiwaii Pae Aina, i na kanaka a pau, i keia la, nona iho, a no kona mau hope Alii, ma hanwi lilo loa aku oia ma ke ano ulouia ia *Kame*

i kona *Maunaloa* kanaka i manao pono ia ia, i kela apina aina a pau e waiho la ma *Lana'i* i na ka Mokuopuni o *Lana'i*; a penei hoi ka waiho ana o na Mokuopuni:

Spana 1 - Ehoomaha (ma ke olehi) Kite Kaha i hui ai me Pate a me Kalaniwahine aia.

Kema	38	Stom	1400	Pau	ma ke Pate
Mau	36 1/2	"	662	"	" (Aupuni)
"	52 1/2	"	950	"	"
"	35 1/2	W.P.	1182	"	" (Aia i Kapuni)
"	70 1/2	"	290	"	"
Kema	52 1/2	"	388	"	" Kalaniwahine
Mau	39 1/2	"	326	"	"
Kema	54 1/2	"	133	"	" Kahakai
"	38 1/2	W.P.	514	"	" Kalaniwahine
"	49	W.P.	700	"	"
20.10 (Pa)					

Spana 2 - Ehoomaha (ma ke olehi) Kite i hui ai me Pate ma Kahakai

Kema	38	Stom	100	Pau	ma ke Pate
Mau	32	"	1555	"	" Ke Kalaniwahine
aia (palo aia) ma ke Kahakai i ke olehi ma					
0.75 (Pa)					

Ke ke (Kulana) o na Hanaka

1865 A 1111 1 1111 1 1111

Handwritten text, likely a list or inventory of items, including names and descriptions in Hawaiian script.

Main body of handwritten text, appearing to be a detailed list or account of transactions, with columns of text and some numerical entries.

u maloko o ia Ajuna _____ 20.85 _____ eka a oi iki aku emi iki mai pala.

Eia ke kumu o ka lilo ana; ua haawi mai oia iloko o ka waipona waiwai o ke Aupuni i

(No date but 20.88)

Aka, ua koe i ke Aupuni na mine 'mineral' a me na mine metala a pau.

No *Keano*

ua nina la i haawiia, no *na* inu loa aku no, mo ke ano alodio a no *kona* inu hooilina, a me ko *me* waipona, ua pili nae ka auhau a ka Poe Ahaolelo e kau like ni ma na nina alodio a pau i kela manawa i keia manawa.

A i nua e ike'a'i, ua kau wai i ko'u inoa, a me ka Sila Nui o ko Hawaii I'ao Aina, ma Honolulu, i keia la *12* o *September* 1865, 18

*By the King
F. W. Robinson*

Manechemcha 12

**Palapala Sila Nui Helu 3045
William Beder**

Ma ke Ahupuaa o Kaunolu, Mokupuni o Lanai.

E hoomaka ma ke kihi Akau
loa o keia apana i hoailona ia
i kekahi papipi maia kihi ka
moe ana aku i ka:

He. 44 ¼ ° Hik. 1370
pauku pili me Aupuni;
He. 33 ¼ ° Kom. 3656
pauku hiki i ke kowa
mawaena o ka Hale;
He. 42 ½ ° Kom. 2668
pauku pili me Aupuni;
Ak. 37 ¾ ° Kom. 2054
pauku pili me Aupuni;
Ak. 30° Hik. 1366 pauku
pili me Aupuni;
Ak. 40 ½ ° Hik. 1990
pauku pili me Kaiwi;
Ak. 51 ½ ° Hik. 2716 pauku
pili me Aupuni;
hiki i ke kihi mua.
O kona ili 128 Eka.

[John Richardson]

Waikapu
Nov. 1855.

Translation:

Starting at the far Northern
Corner of this parcel marked
By a cattle pen, and at this
corner then it is laid out to the:

South 44 ¼ ° East 1370
links along the
Government;
South 33 ¼ ° West 3656
links to the space
between the House;
South 42 ½ ° West 2668 Links
along the Government;
North 37 ¾ ° West 2054 links along the Government;
North 30° East 1366 links along the Government;
North 40 ½ ° East 1990 links along Kaiwi;
North 51 ½ ° East 2716 links along the Government;
to the first corner.
Containing 128 Acres.

Waikapu Nov 1855. [Maly, translator]

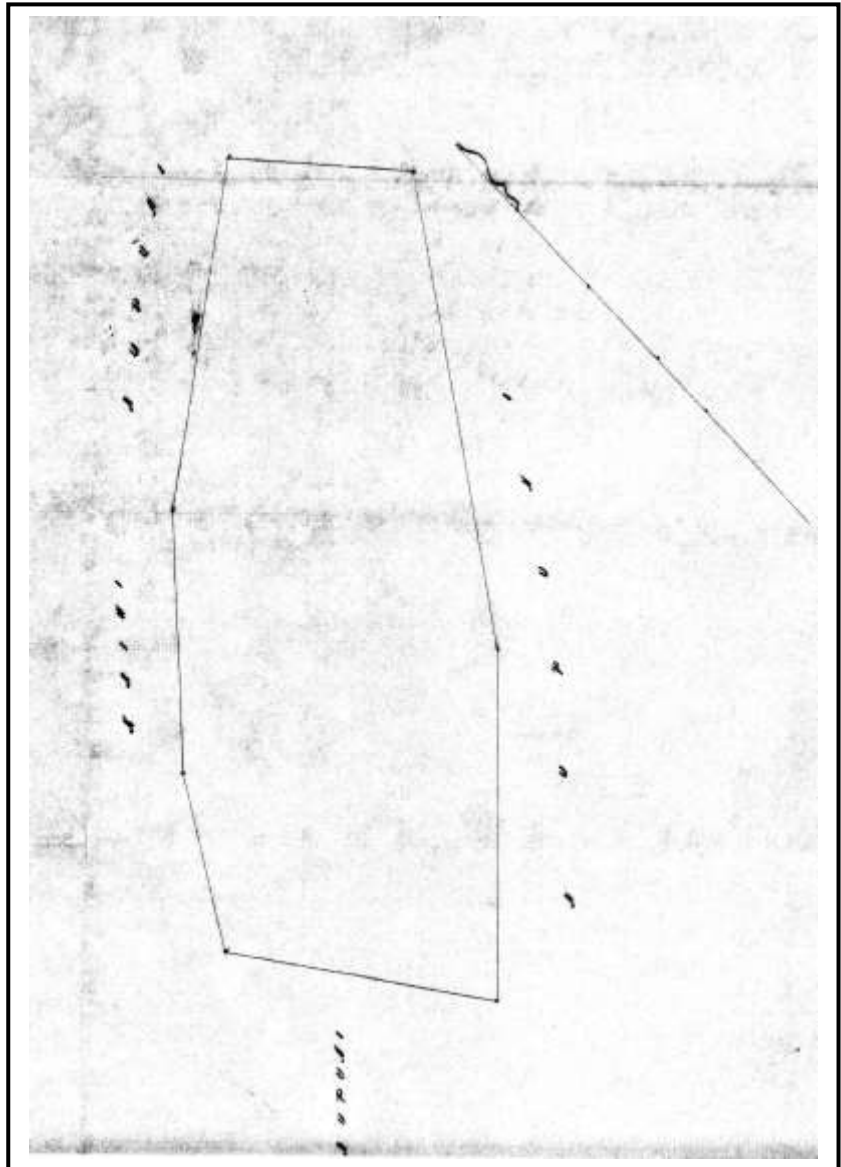

**Figure 13. Notes of Survey for Royal Patent Land
Grant No. 3030 to William Beder, at
Kaunolu. Hawaii State Archives.**

HELU 3045
PALAPALA SILA NUI.

Ma keia Palapala Sila Nui ke hoike aku nei o Kamehameha IV., ke Alii nui a ke Akua i kona lokomaikai i hoonoho ai maluna o ko Hawaii Pae Aina, i na kanaka a pau, i keia hi, noua iho, a no kona mau Impe Alii, ua luawai lilo loa aku oia ma ke noo aloha ia *William Bedes* i kona kanaka i maunaloa pono ia ia, i kela upuna aia a pau e waiho la ma ma ka Mokuamoi o *Kaunolu Lanai* i a peue hui ku waiho ana o na Mokuamoi:

*Moemaka (ma ke Kahi) Mau - hooaitena ia
i Kahahe Papihi maia Kahi ka moe ana aku i ka
Hema 40 1/2 1812 1370 i aia me Kupuni
" 33 1/2 kom 3656 " " " " *ka Kawa maunaloa
ona hali.*
" 42 1/2 " 2668 " " " "
Man 37 1/2 " 2054 " " " "
" 30 1812 1366 " " " "
" 40 1/2 " 1990 " " *Kaiwi*
" 51 1/2 " 2716 " " *Kupuni*
Ke 128 ha
Noe hoo ka Mokuamoi - na Manaloa*

1857 A. 1128 B. 1128 A. 1128

a maloko o ia Apana 128 eka a oi iki aku eni iki mai paha.
 Eia ke Kumu o ka lilo aua; ua haawi mai oia iloko o ka waihoia waiwai o ke Aupuni i
(Ma dala ho 1128.00)
 Aka, ua koe i ke Aupuni na mine minerala, a me na mine metala a pau.
 No *William B. Decker*
 ua aiaa la i hoawili, no *na* mau loa aku no, ma ke ano alodio a no ko *na* mau hooidina, a me ke
na waihoia, ua pili nae ka auhau a ka Poe Ahaolelo e kau like ai ma na aina alodio a pau i kela
 mauwa i keia mauwa.

I i mea e ika'i, ua kau wau i ko'u inoa, a me ka Sila Nui o ko Hawaii Pae Aiea,
 ma Honolulu, i keia la 1 o *Februan*, 1867

By the King
Wm. K. Kalanikouli
Kamehameha III

For documentation on the later disposition of the Royal Patent Grants issued to the individuals cited above, please see the manuscript comprised of the conveyances of land recorded in the Bureau of Conveyances.